

FILED

MAR 14 2024

JEANNIE GOFF *JG*
COUNTY CLERK, JEFFERSON COUNTY, MO

BILL NO.: 24-0301

ORDINANCE NO.: 24-0147

INTRODUCED BY: COUNCIL MEMBER(S) *Gwoetke*

1 **AN ORDINANCE TO AUTHORIZE THE COUNTY EXECUTIVE TO**
2 **EXECUTE CHANGE ORDER NUMBER 2 FOR THE HIGH RIDGE**
3 **BOULEVARD-SHARED PATH PROGRAM WITH INFRASTRUCTURE**
4 **MANAGEMENT, INC. IN COUNCIL DISTRICT 1.**

5 **WHEREAS**, Jefferson County, Missouri, (hereafter, the “County”), in response to
6 a certain Invitation for Bid, received and opened bids for the construction of the High Ridge
7 Boulevard-Shared Path Program; and

8 **WHEREAS**, after reviewing the bids set forth above, the County determined that
9 it was in the best interests of the County to award the bid for the High Ridge Boulevard-
10 Shared Path Program to Infrastructure Management, Inc. upon approval by the County
11 Council and the County Executive; and

12 **WHEREAS**, Pursuant to Ordinance 23-0178, Jefferson County, Missouri entered
13 into a Contract with Infrastructure Management, Inc. in the amount of two million, six
14 hundred forty-seven thousand, three hundred seventy-two dollars and eighty cents
15 **(\$2,647,372.80)**, subject to budgetary limitations, for the High Ridge Boulevard-Shared
16 Path Program; and

17 **WHEREAS**, the Jefferson County, Missouri Council passed Ordinance 24-0110 on
18 February 2, 2024, authorizing the County Executive to enter into Change Order No. 1 to

1 the construction contract with Infrastructure Management for an increase of forty-six
2 thousand, three hundred eleven dollars and eighty cents (**\$46,311.80**) to the contract sum,
3 subject to budgetary limitations; and

4 **WHEREAS**, the County finds that it is now necessary to adjust some quantities of
5 pay items in the contract. The differences in contract quantities reflect the necessary
6 changes made in the field and the actual final quantities of work. These figures represent
7 the difference between the value of construction and materials shown in the bid package
8 and the final quantities used and measured during construction; and

9 **WHEREAS**, the Jefferson County Council finds that it is now necessary and in the
10 best interest of the County to execute Change Order Number 2 for an increase of sixteen
11 thousand, four hundred ninety dollars and fifteen cents (**\$16,490.15**) to the contract sum,
12 subject to budgetary limitations with Infrastructure Management, Inc. for the High Ridge
13 Boulevard-Shared Path Program Contract.

14 **BE IT ENACTED BY THE JEFFERSON COUNTY, MISSOURI, COUNCIL,**
15 **AS FOLLOWS:**

16 Section 1. Change Order Number 2 for an increase of sixteen thousand, four
17 hundred ninety dollars and fifteen cents (**\$16,490.15**) to the contract sum with
18 Infrastructure Management, Inc. for the High Ridge Boulevard-Shared Path Program
19 Contract, for a revised total cost of two million, seven hundred ten thousand, one hundred
20 seventy-four dollars and seventy-five cents (**\$2,710,174.75**) is approved, subject to
21 budgetary limitations.

1 Section 2. The Jefferson County, Missouri, Council authorizes the County
2 Executive to execute Change Order Number 2 to the High Ridge Boulevard-Shared Path
3 Program with Infrastructure Management, Inc. and any agreements or contracts necessary
4 to effectuate the award of the bids and proposals set forth in this Ordinance. The County
5 Executive is further authorized to take any and all actions necessary to carry out the intent
6 of this Ordinance.

7 Section 3. Copies of all Invitations for Bid, response thereto, any contract
8 agreements and Change Orders shall be maintained by the Department of the County Clerk
9 consistent with the rules and procedures for the maintenance and retention of records as
10 promulgated by the Secretary of State.

11 Section 4. This Ordinance shall be in full force and effect from and after its date
12 of approval. If any part of this Ordinance is invalid for any reason, such invalidity shall
13 not affect the remainder of this Ordinance.

[THIS SPACE INTENTIONALLY LEFT BLANK]

THIS BILL BEING DULY INTRODUCED, THE MEMBERS OF THE JEFFERSON COUNTY, MISSOURI, COUNCIL VOTED AS FOLLOWS:

Council Member District 1, Brian Haskins	<u>absent</u>
Council Member District 2, Gene Barbagallo	<u>yes</u>
Council Member District 3, Lori Arons	<u>yes</u>
Council Member District 4, Charles Groeteke	<u>yes</u>
Council Member District 5, Scott Seek	<u>yes</u>
Council Member District 6, Daniel Stallman	<u>absent</u>
Council Member District 7, Bob Tullock	<u>yes</u>

THE ABOVE BILL ON THIS 11 DAY OF March, 2024:

PASSED FAILED



Charles Groeteke, County Council Chair



Cherlynn Boyer, Council Executive Assistant

THIS BILL WAS ✓ APPROVED BY THE JEFFERSON COUNTY EXECUTIVE AND ENACTED AS AN ORDINANCE OF JEFFERSON COUNTY, MISSOURI, THIS 13 DAY OF March, 2024.

THIS BILL WAS _____ VETOED AND RETURNED TO THE JEFFERSON COUNTY, MISSOURI, COUNCIL WITH WRITTEN OBJECTIONS BY THE JEFFERSON COUNTY EXECUTIVE, THIS _____ DAY OF _____, 2024.



Dennis Gannon, County Executive

ATTEST:

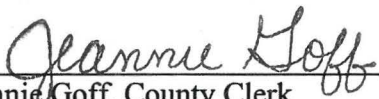

Jeannie Goff, County Clerk

BY: 

Reading Date: 3-11-2024



ORDINANCE NO.

24-0147

CHANGE ORDER - #2

EXHIBIT A

Sheet 1 of 3

Change Order No. 2
 County Jefferson
 Route High Ridge Boulevard
 Project High Ridge Boulevard Improvements
 Job No. TAP-5445 (601)

To: Infrastructure Management, Inc.
 You are hereby directed to make the following changes to the contract.

1. Description and Reason for Change (Attach Supplemental Sheets if Required)
 See attached sheets

2. Estimate of Cost of Work Affected by this Change Order.

(A) EST. LINE NO.	(B) CONTRACT ITEM NO.	(C) ITEM DESCRIPTION	(D) UNITS PREVIOUSLY PROVIDED FOR	(E) UNITS TO BE CONSTRUCTED	(F) UNITS OVERRUN UNDERRUN CONTINGENT	(G) CONTRACT OR AGREED UNIT PRICE	(H) AMOUNT OF OVERRUN OR PLUS CONTINGENT	(I) AMOUNT OF UNDERRUN OR MINUS CONTINGENT
8	6085006	Concrete Approach, 7" (Remove & Replace) (includes 4" Type 5 Aggregate)	25179	23817	(1,362.0)	\$10.05	-	-\$13,688.10
-	SPL-CO2-1	Bituminous Pavement Mixture PG70-22 (BP-1)	0	55	55.0	\$267.55	\$14,715.25	-
-	SPL-CO2-2	Remove existing parking area and install new Bituminous Pavement Mixture PG70-22 (BP-1)	0	179	179.0	\$66.50	\$11,903.50	-
72	9011000	Concrete Street Light Base	31	29	(2.0)	\$1,080.00	-	-\$2,160.00
-	SPL-CO2-3	Concrete Street Light Base Alternate	0	2	2.0	\$2,859.75	\$5,719.50	-
TOTALS							\$32,338.25	-\$15,848.10

3. Settlement for Cost of the above Change to be made at Contract Unit Price

1. Contract Amount	\$2,647,372.80	The Terms of Settlement outlined above are hereby agreed to. <u>Infrastructure Management, Inc.</u> Contractor by: _____ Date _____
2. Overrun This Order	\$16,490.15	
3. Overrun Previous	\$46,311.80	
4. Total Overrun to Date	\$62,801.95	
5. Total	\$2,710,174.75	

[Signature]
 Submitted Engineer
[Signature]
 Approval County Executive

3/1/24
 Date
3/13/24
 Date

Approval Recommended MODOT _____ Date _____
 Approval MODOT Construction _____ Date _____

FIG. XI - 2



Approved as to Form:

[Signature]
 County Counselor
 Jefferson County, Missouri

Change Order #2 – Reasons Attachment

ROADWAY ITEMS:

- Item 1:** 6085006 – Concrete Approach, 7” (Remove & replace) (includes 4” Type 5 Aggregate Base) - Underrun of 1,362 SF @ \$10.05 / SF (This is an original contract item.)
- Item 2:** SPL-CO2-1 – Bituminous Pavement Mixture PG70-22 (BP-1) (includes 4” Type 5 Aggregate Base) - Overrun of 55 Tons @ \$267.55 / Ton (This is an agreed upon price item.)
- Item 3:** SPL-CO2-2 – Remove existing parking area and install new Bituminous Pavement Mixture PG70-22 (BP-1) (includes 4” Type 5 Aggregate Base) - Overrun of 179 Square Yards (40 Tons) @ \$66.50 / Square Yard (This is an agreed upon price item.)

LANDSCAPING/STREETSCAPING ITEMS:

- Item 4:** 9011000 – Concrete Street Light Base - Underrun of 1 EA @ \$1,080.00 / EA (This is an original contract item.)
- Item 5:** SPL-CO2-3 – Concrete Street Light Base Alternate - Overrun of 2 EA @ \$2,859.75 / EA (This is an agreed upon price item.)

ROADWAY ITEMS:

- Item 1:** This item is a underrun by 1,362 CY. This is the tie in approaches to the parking lots of the businesses to be replace with asphalt (as this will allow us to mold to the existing asphalt and have a better product. Using the concrete would create +/- 2’ drives of up to 17%.
- Item 2** This item is an overrun of approximately 55 Tons. This is to replace the concrete approach tie ins at the parking lots of the businesses. This will better conform to the existing asphalt and not have drives of +/- 2’ up to 17%.
- Item 3** This item is an overrun of approximately 179 square yards. This is to replace the concrete approach tie in at the parking lot of the tHAIRapy business. Per the original design, the parking stalls would have a slope in the back 4’-5’ of 10 to 14% and would prevent the business from having an ADA parking spot.

LANDSCAPING/STREETSCAPING ITEMS:

- Item 4:** This item is a underrun. This is due to the light being designed over a proposed storm sewer line. The base cannot be installed due to the shallow depth of the storm sewer line.

Item 5: This item is a overrun. This is due to multiple lights being designed over a proposed storm sewer line. The original base cannot be installed due to the shallow depth of the storm sewer line and will require the alternate base (spread base) to properly install the light at the location.

APPROVED AS TO FORM

ATTEST: Jeannie Goff
COUNTY CLERK

[Signature]
COUNTY COUNSELOR

Shelley Blankenship
DEPUTY CLERK

I hereby certify under section 50.660 RSMo there is either: (1) a balance of funds, otherwise unencumbered, to the credit of the appropriation to which the obligation contained herein is chargeable, and a cash balance otherwise unencumbered, in the treasury, to the credit of the funds from which payment is to be made, each sufficient to meet the obligation contained herein; or (2) bonds or taxes have been authorized by vote of the people and there is a sufficient unencumbered amount of the bonds yet to be sold or of the taxes levied and yet to be collected to meet the obligation in case there is not a sufficient unencumbered cash balance in the treasury.

Kristy Cooper
COUNTY AUDITOR

CONTINGENT ITEM PRICE CHECK

Contract ID Infrastructure Mgmt., Inc. Job No. TAP 5445 (601) Change Order No. 2
Route High Ridge Boulevard County Jefferson
Item Description Bituminous Pavement Mixture PG70-22 (BP-1)
Item Code SPL-CO2-1 (4011207) Proposed Price/Unit \$267.55/Ton
Line Number 2 Units to be Constructed 95

MoDOT Unit Bid Price Book Comparison:

Year 2022 Statewide Average Price 79.88 Average Quantity 41,993.70
District SL Average Price 547.00 Average Quantity 5.900

Comparison With Prices on Other Area Projects:

Route N/A County N/A Job No. N/A
Price N/A Quantity N/A

Remarks/Other Analysis/Considerations:

The agreed upon price for using Bituminous Pavement is to adjust the profiles to have better slope percentages for tying in the sidewalk to the existing drives and parking lots. This will be all hand work and not by a paver. This quantity is estimated and price is not comparitively to Imperial Main Street as this work was done by a paver. The price submitted is acceptable to the County.

Is the proposed price approved: Yes By Whom? Taylor Stuart
Date approved/rejected 02/02/2024 Contractor notified? Yes

Responsible Person: <u>Taylor Stuart</u> Date: <u>02/02/2024</u>

Infrastructure Management, Inc
PO Box 270371
St. Louis, MO 63127
314 843-7100

January 30, 2024

Taylor Stuart
Department of Public Works
P.O. Box 100
Hillsboro, MO 63050

Project: **High Ridge Blvd Shared Use Path
TAP-5445(601)**

RE: **Asphalt Wedging for Grade Transition**

Dear Mr. Stuart:

As per your request, please find the following unit pricing to construct an asphalt wedge to serve as a grade transition from the new improvements to existing pavement elevations. The asphalt wedges will be used primarily behind the new concrete approaches. The wedges will be roughly 4' in depth and average 3" in thickness. Hand work will be required for the wedge construction.

55 T Commercial Asphalt @ 80.00/T	4,400.00
Misc Tack Coat	60.00
1 Skid Loader with Operator 21 HR @ 110/HR	2,310.00
1 Roller with Operator 21 HR @ 110/HR	2,310.00
3 Laborers 21 HR @ 50.51/HR	<u>3,182.13</u>
Subtotal	12,262.13
+20% OH&P	<u>2,452.43</u>
Total	\$14,714.56

Therefore, $\$14,714.56 / 55T = \$267.54/\text{Ton}$ for wedge asphalt.

Please contact me if you should have any questions.

Sincerely,

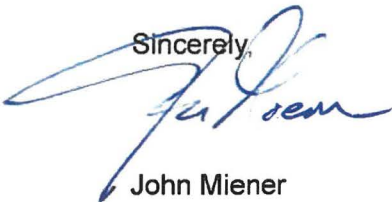

John Miener
Infrastructure Management, Inc.
314 280.0354

PAY ITEM	DESCRIPTION	UNIT	AVERAGE QUANTITY	#OF BIDS	AVERAGE PRICE	HIGH BID	LOW BID	TOTAL QUANTITY
3040183	TYPE 1 AGGREGATE FOR BASE (8 IN. THICK)	S.Y.	1,163.750	4	\$13.65	\$16.00	\$10.00	4,655.000
3040504	TYPE 5 AGGREGATE FOR BASE (4 IN. THICK)	S.Y.	5,559.987	52	\$7.40	\$260.00	\$1.00	289,119.300
3040506	TYPE 5 AGGREGATE FOR BASE (6 IN. THICK)	S.Y.	3,034.875	16	\$10.46	\$54.00	\$7.50	48,558.000
3101003	GRAVEL (A)	S.Y.	784.500	4	\$8.67	\$70.00	\$8.00	3,138.000
3102002	CRUSHED STONE (B)	TON	491.000	6	\$53.70	\$71.00	\$38.47	2,946.000
3105002	GRAVEL (A) OR CRUSHED STONE (B)	TON	154.462	13	\$74.18	\$430.50	\$20.89	2,008.000
3105003	GRAVEL (A) OR CRUSHED STONE (B)	S.Y.	1,139.000	6	\$10.46	\$250.00	\$5.00	6,834.000
4010150	TYPE A2 SHOULDER	S.Y.	1,985.257	14	\$60.90	\$180.00	\$39.00	27,793.600
4010151	TYPE A3 SHOULDER	S.Y.	802.400	3	\$55.33	\$63.00	\$48.00	2,407.200
4011207	BITUMINOUS PAVEMENT MIXTURE PG70-22, (BP-1)	TON	5.900	3	\$547.00	\$986.00	\$275.00	17.700
4011209	BITUMINOUS PAVEMENT MIXTURE PG64-22, (BP-1)	TON	2,236.746	35	\$91.92	\$550.00	\$64.50	78,286.100
4011211	BITUMINOUS PAVEMENT MIXTURE PG64-22, (BP-2)	TON	7,713.367	9	\$100.81	\$190.00	\$77.50	69,420.300
4011231	BITUMINOUS PAVEMENT MIXTURE	TON	2,596.780	5	\$107.60	\$615.00	\$93.70	12,983.900
4013000	BITUMINOUS PAVEMENT MIXTURE PG64-22 (BASE)	TON	130.644	18	\$208.40	\$550.00	\$109.30	2,351.600
4020520	BITUMINOUS PAVEMENT MIXTURE PG64-22	TON	7,276.500	7	\$84.14	\$92.00	\$80.00	50,935.500
4020521	BITUMINOUS PAVEMENT MIXTURE	TON	5,480.500	2	\$113.50	\$125.00	\$102.00	10,961.000
4030008	ASPHALTIC CONCRETE MIXTURE PG 76-22 (SP095BSMR MIX)	TON	6,973.000	4	\$130.73	\$135.00	\$125.00	27,892.000
4030009	ASPHALTIC CONCRETE MIXTURE PG 76-22 (SP095BSM MIX)	TON	16,591.300	5	\$109.53	\$290.00	\$105.00	82,956.500
4030011	ASPHALTIC CONCRETE MIXTURE PG 70-22 (SP095CLP MIX)	TON	17,030.200	5	\$100.06	\$115.55	\$85.50	85,151.000

CONTINGENT ITEM PRICE CHECK

Contract ID Infrastructure Mgmt., Inc. Job No. TAP 5445 (601) Change Order No. 2
Route High Ridge Boulevard County Jefferson
Item Description Remove existing parking area and install new Bituminous Pavement Mixture PG70-22 (BP-1)
Item Code SPL-CO2-2 Proposed Price/Unit \$66.50/SY
Line Number 3 Units to be Constructed 179

MoDOT Unit Bid Price Book Comparison:

Year N/A Statewide Average Price N/A Average Quantity N/A
District N/ Average Price N/A Average Quantity N/A

Comparison With Prices on Other Area Projects:

Route N/A County N/A Job No. N/A
Price N/A Quantity N/A

Remarks/Other Analysis/Considerations:

I could not find a price comparison for this item as it involved removal of the existing parking area and placement of new bituminous pavement with type 5 base rock. I checked to see if the County has done anything like this in the last couple of years and did not find any estimates. The price is similar to their other quote for hand work, as they will have to place the pavement with a skid loader. The County is good with this quote.

Is the proposed price approved: Yes By Whom? Taylor Stuart
Date approved/rejected 02/02/2024 Contractor notified? Yes

Responsible Person: <u>Taylor Stuart</u> Date: <u>02/02/2024</u>

**Infrastructure Management, Inc
PO Box 270371
St. Louis, MO 63127
314 843-7100**

January 31, 2024

Taylor Stuart
Department of Public Works
P.O. Box 100
Hillsboro, MO 63050

Project: **High Ridge Blvd Shared Use Path
TAP-5445(601)**

RE: **Parking Lot Grade Correction at 2916 High Ridge Blvd**

Dear Mr. Stuart:

As per your request, please find the following unit pricing to excavate approximately 185 SY of the existing parking lot and construct new asphalt pavement. The new pavement section is to be two compacted 2" lifts of commercial asphalt over 4" Type 5 Base Rock. The lot excavation will average 12" in depth. The finished 4" thick asphalt will match the streetside elevations of the project's improvements.

We propose to perform the above scope of work (excavation, base rock and asphalt) for the unit price of \$66.50/SY. The current tenant at this address is Thairapy Salon & Spa.

Please contact me if you should have any questions.

Sincerely,

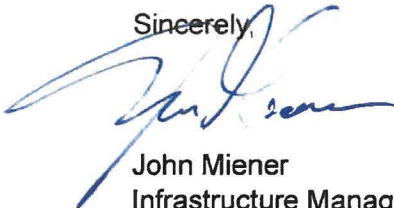

John Miener
Infrastructure Management, Inc.
314 280.0354

CONTINGENT ITEM PRICE CHECK

Contract ID Infrastructure Mgmt., Inc. Job No. TAP 5445 (601) Change Order No. 2
Route High Ridge Boulevard County Jefferson
Item Description Base, Concrete (alternate)
Item Code SPL-CO2-3 (9109100) Proposed Price/Unit \$2,859.75/EA
Line Number 5 Units to be Constructed 2

MoDOT Unit Bid Price Book Comparison:

Year 2022 Statewide Average Price 2,706.10 Average Quantity 5.00
District SL Average Price N/A Average Quantity N/A

Comparison With Prices on Other Area Projects:

Route N/A County N/A Job No. N/A
Price N/A Quantity N/A

Remarks/Other Analysis/Considerations:

The agreed upon price for using the alternate concrete base is due to the fact that the lights were designed on top of the storm sewer. The storm sewer was not designed deep enough for the original light base to be constructed without it concrete base going through the storm line.

Is the proposed price approved: Yes By Whom? Taylor Stuart
Date approved/rejected 02/02/2024 Contractor notified? Yes

Responsible Person: <u>Taylor Stuart</u> Date: <u>02/02/2024</u>

**Infrastructure Management, Inc
PO Box 270371
St. Louis, MO 63127
314 843-7100**

January 29, 2024

Taylor Stuart
Department of Public Works
P.O. Box 100
Hillsboro, MO 63050

Project: **High Ridge Blvd Shared Use Path
TAP-5445(601)**

RE: **Light Standard Spread Footing Base**

Dear Mr. Stuart:

As per your request, please find the following unit pricing to construct a spread footing light base, where required, due to foundation depth constraints on the subject project:

Augured Deep Foundation (Plan Unit Price)	1,080.00
Additional Cost for Spread Footing (Meyer)	1,695.00
+ 5% OH&P	<u>84.75</u>
Total Additional Cost	1,779.75

Therefore, total unit price for Spread Footing is **\$2,859.75**

Please contact me if you should have any questions.

Sincerely,

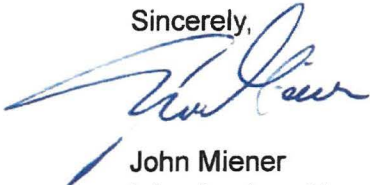

John Miener
Infrastructure Management, Inc.
314 280.0354

Meyer Electric Co., Inc.

3513 North Ten Mile Drive
Jefferson City, MO 65109

Phone: (573) 893-2335

Fax: (573) 893-3686

E-mail: office@meyerelectric.net

October 26, 2023

Infrastructure Mgmt, Inc.
St. Louis, MO

Attn: John Miener

Re: Jefferson County High Ridge Blvd
Shared Use Path
Spread Footing Base
Meyer Electric #ME38258

Dear John:

The following is the additional cost to install a spread footing arrangement per attached drawing in lieu of drill pier and pouring concrete light pole base.

Additional excavation and backfill. Removal of spoils:

Excavator & Operator – 5 hrs x \$195.00	\$975.00
Sonotube	\$30.00

Additional Labor:

Form up base, sonotube	
Place steel	
Pour concrete	
Crumb out excavation on base	
2 men – 3 hrs x \$115.00	<u>\$690.00</u>

\$1,695.00 per each

Please advise if we can be of further service.

Sincerely,

MEYER ELECTRIC CO., INC.

Leon J. Keller

Leon J. Keller, President

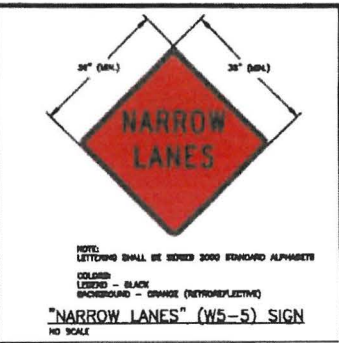
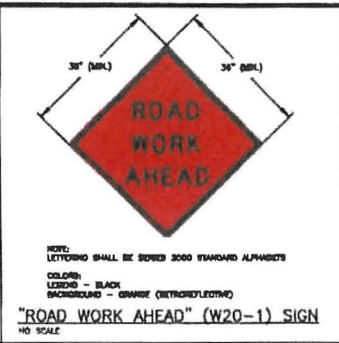
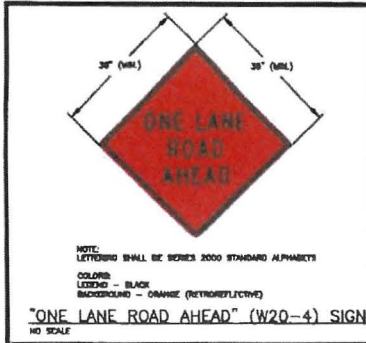

- KEYED NOTES**
- (1) RADIUS TO INSIDE OF ROUND TE IS 8"
 - (2) 3/8" X 4" NON-OSSING EXPANSION JOINT MATERIAL.
 - (3) LIGHT POLE MANUFACTURER SUPPLIED GALVANIZED STEEL ANCHOR BOLTS.

NOTES:
CONTRACTOR SHALL EXCAVATE FOR STREET LIGHT BASE WITH AN AUGER. OTHER EXCAVATION METHODS MAY BE CONSIDERED, WITH PRIOR APPROVAL FROM ENGINEER.

IF USED, FIBER FORM TUBES SHALL EXTEND A MAXIMUM OF 12" BELOW GROUND LEVEL. THE REMAINING CONCRETE BASE SHALL BE POURED AGAINST UNDISTURBED EARTH. ANY BACKFILL HEEDED SHALL BE 3/4" MINUS AGGREGATE, COMPACTED IN 8" LIFTS.

ALTERNATE BASE SHALL ONLY BE USED IF APPROVED BY THE CITY. NO CHANGE IN COSTS WILL BE MADE IF THE ALTERNATE BASE IS USED.

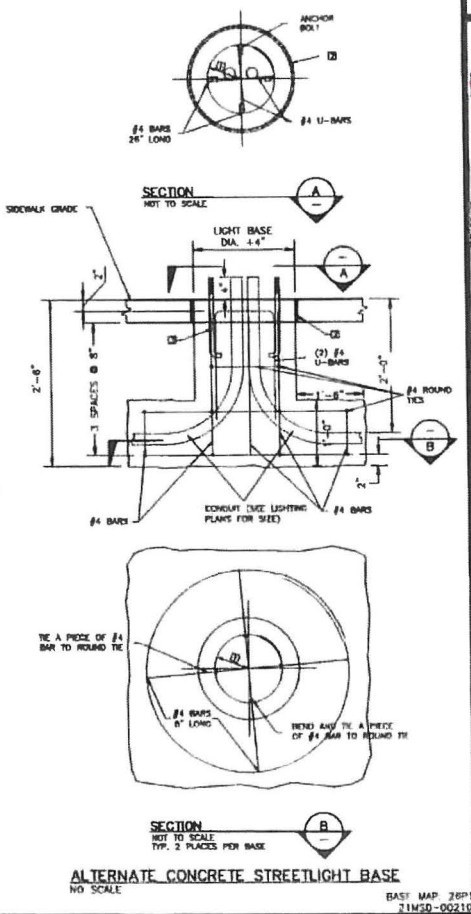
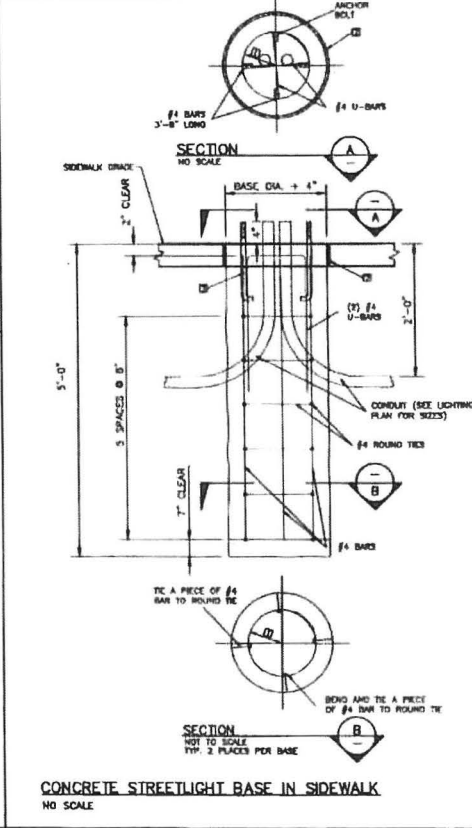
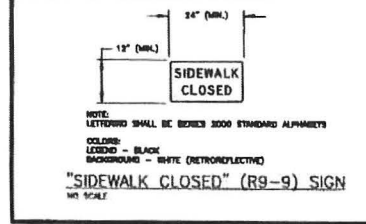
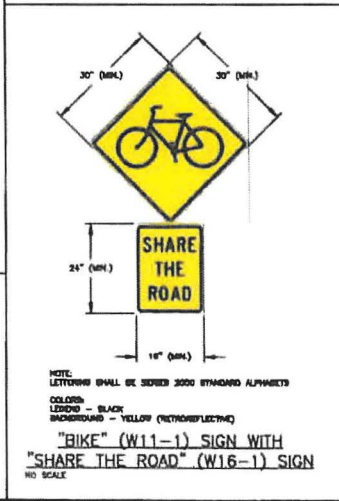
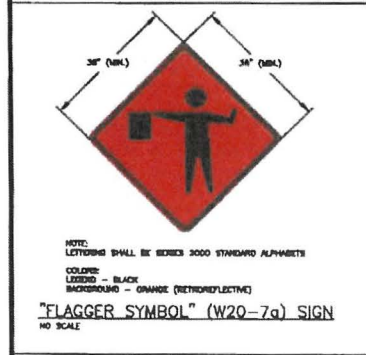
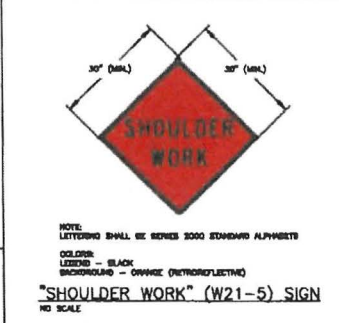
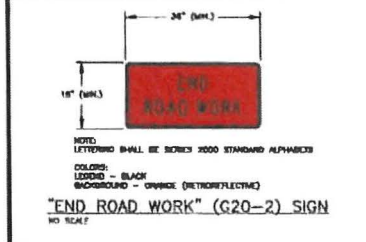

ST. LOUIS AVE. IMPROVEMENTS PH. 2
 FEDERAL PROJECT NO. STP-9901(648)
 CITY OF VALLEY PARK, MISSOURI

DE-17

ST. LOUIS AVE. IMPROVEMENTS PH. 2
FEDERAL PROJECT NO. STP-9901(648)
CITY OF VALLEY PARK, MISSOURI

DATE: _____
 DRAWN BY: _____
 CHECKED BY: _____
 JULY 2021
 SCALE: 1" = 20'
 SHEET NO. 10 OF 10
 PROJECT NO. STP-9901(648)

Drawing Number: JLM11-08-03 Date: 07/14/21 2:00 PM Project: ST. LOUIS AVE. IMPROVEMENTS PH. 2 (FEDERAL PROJECT NO. STP-9901(648)) City: VALLEY PARK, MISSOURI

PAY ITEM	DESCRIPTION	UNIT	AVERAGE QUANTITY	#OF BIDS	AVERAGE PRICE	HIGH BID	LOW BID	TOTAL QUANTITY
9108810	PULL BOX, PREFORMED CLASS 1	EACH	4.167	6	\$1,485.24	\$1,903.00	\$1,250.00	25.000
9108811	PULL BOX, PREFORMED CLASS 2	EACH	2.429	7	\$2,207.71	\$2,521.00	\$1,873.00	17.000
9108816	PULL BOX, PREFORMED CLASS 5	EACH	3.263	19	\$2,468.02	\$3,803.00	\$2,100.00	62.000
9108820	PULL BOX, CONCRETE, STANDARD	EACH	27.250	4	\$3,265.65	\$3,779.52	\$2,885.00	109.000
9108821	PULL BOX, CONCRETE, DOUBLE,	EACH	5.000	1	\$4,875.00	\$4,875.00	\$4,875.00	5.000
9109100	BASE, CONCRETE	C.Y.	5.000	4	\$2,706.10	\$3,245.00	\$2,176.00	20.000