

AGREEMENT FOR SHARED COSTS IN
THE OPERATION AND MAINTENANCE OF
SHARED LINES AND PUMPING STATIONS

THIS AGREEMENT made this 9th day of June, A.D., 1981 by and between the Owosso Township - Caledonia Township Utility Authority (hereinafter called The Utility Authority) and the City of Corunna (hereinafter called Corunna) all of which are public corporations or have been established by public corporations and are located in the County of Shiawassee and State of Michigan;

WITNESSETH:

WHEREAS, the Owosso Township - Caledonia Township Utility Authority is charged with the operation and maintenance of sanitary sewer lines and certain pumping stations in Owosso Township and Caledonia Township; and

WHEREAS, the City of Corunna has constructed its own sanitary sewer lines and its sewage is conveyed through the Utility Authority lines by means of Utility Authority pumping stations, and

WHEREAS, the City of Owosso has constructed and enlarged its sewage treatment facilities for the express purpose of treating the sanitary sewage of Owosso Township, Caledonia Township, City of Corunna and the City of Owosso; and

WHEREAS, it is beneficial to the Utility Authority and Corunna from both an economical and a health standpoint and it is necessary to provide for the sharing of the costs for the operation and maintenance of the Utility Authority sewer lines and pumping stations which the Utility Authority shares with Corunna.

THEREFORE, it is agreed by and between the parties hereto as follows:

Article I. Pumping Station No. 8, That Corunna's costs for the operation and maintenance of Pumping Station No. 8, which is located near the Shiawassee River in Caledonia Township and is identified as Point G on Exhibits "B" and "C" attached hereto and made a part hereof, shall be their share of the total operation and mainten-

ance cost (hereinafter referred to as TOM) of Station No. 8, of which said cost includes actual electrical expenses, actual materials for any repair or replacement and actual labor. Labor performed by the Utility Authority shall be verified by a log book located at Pumping Station No. 8, in which the number of hours worked shall be recorded.

Any additional costs which are not stated above but which were incurred for operation and maintenance shall be submitted to Corunna for their review for reasonableness. Corunna's approval for said costs shall not be unreasonably withheld.

The TOM shall then be multiplied by Corunna's total sewage flow which shall be metered.

The above answer derived shall then be divided by Pumping Station No. 8, total flow. This flow will be metered at Metering Station No. 2, on North Hickory Road, which is identified as Point D on Exhibits "B" and "C" attached hereto and made a part hereof.

This answer is the cost to the City of Corunna towards portions of the operation and maintenance of Pumping Station No. 8. (Please refer to Exhibit "A" attached hereto which sets forth the formula above-mentioned.)

Article II. Pumping Station No. 7, That Corunna's costs for the operation and maintenance of Pumping Station No. 7, which is located in Caledonia Township near the Caledonia Township Hall on North State Road and is identified as Point H on Exhibits "B" and "C" attached hereto and made a part hereof, shall be their share of the total operation and maintenance costs (hereinafter referred to as TOM) of Station No. 7, of which said cost includes actual electrical expenses, actual materials for any repair or replacement and actual labor. Labor performed by the Utility Authority shall be verified by a log kept at Station No. 7, in which the number of hours worked shall be recorded.

Any additional costs which are not stated above but which were incurred for operation and maintenance shall be submitted to Corunna for their review for reasonableness. Corunna's approval for said costs shall not be unreasonably withheld.

That TOM shall then be multiplied by the total number of units charged to Corunna customers.

The above answer derived shall then be divided by the total units charges through said station.

This figure is the cost to the City of Corunna for its portion of the operation and maintenance of Pumping Station No. 7. (Please refer to Exhibit "A" attached hereto which sets forth the formula as above-mentioned.)

The total number of units charged through Station No. 7 shall be determined by Utility Authority Administration. The Utility Authority's books and records kept and used for the purpose of determining the "units charged" shall be open for inspection by Corunna after reasonable notice.

The total number of units charged to Corunna customers shall be based upon the Oakland County Unit System and/or actual metered flow as Corunna shall determine. For the purpose of conversion into units, 6,000 gallons is equal to one unit. Corunna's books and records kept and used for the purpose of determining the "units charged" shall be open for inspection by the Utility Authority after reasonable notice.

Article III. Shared Lines, That Corunna's costs for repair and major maintenance for the operation and maintenance of shared lines shall be the total repair and major maintenance costs of the shared lines. Shared lines shall be defined and are located on Exhibits "B" and "C" attached hereto and made a part hereof.

The total repair and major maintenance costs shall then be multiplied by the design flow engineered for Corunna. For the design flow of Corunna shared lines, please refer to Exhibit "B" attached hereto and made a part hereof.

This answer shall then be divided by the total design flow capacity which can be determined by reference to Exhibit "B" attached hereto and made a part hereof. The resulting answer is thus the total cost to the City of Corunna for its portion of the total repair and major maintenance costs for shared lines as defined herein. (Please refer to Exhibit "A" attached hereto which sets forth the formula above-mentioned.)

Article IV. This Agreement shall be in full force and effect so long as Pumping Station No. 7 and No. 8 are in operation

and as long as the Utility Authority and Corunna have shared lines unless sooner terminated by the parties hereto, and shall inure to the benefit and be binding upon the parties hereto, their successors and assigns.

IN WITNESS WHEREOF, the parties have executed this Agreement on the first date set forth above.

CITY OF CORUNNA

OWOSSO TOWNSHIP - CALEDONIA
TOWNSHIP UTILITY AUTHORITY

BY: *Alphonse C. Claborn*

Mayor

BY: *Richard J. [unclear]*

Utility Authority Chairman

BY: *Linda [unclear]*

City Clerk

The above action by the Utility Authority has been ratified and adopted by the following Townships:

DATED: *June 8*, A.D., 1981

TOWNSHIP OF OWOSSO

BY: *Earl Reed*
Supervisor

BY: *Maureen Thornburg*
Clerk

DATED: *June 8*, A.D., 1981

TOWNSHIP OF CALEDONIA

BY: *Earl LaRoue*
Supervisor

BY: *Marjorie Renwick*
Clerk

1. Pumping Station No. 8:

$$\text{TOM} \times \frac{\text{Corunna's flow}}{\text{Total Pumping Station flow}} = \text{Corunna's costs}$$

2. Pumping Station No. 7:

$$\text{TOM} \times \frac{\text{Units charged Corunna customers}}{\text{Total unit charged through station}} = \text{Corunna's cost}$$

3. Repair and Major Maintenance of Shared Lines:

$$\frac{\text{Total repair and Major Maintenance Cost} \times \frac{\text{Design flow for Corunna}}{\text{Total Design flow}}}{\text{Total Design flow}} = \text{Corunna's cost}$$

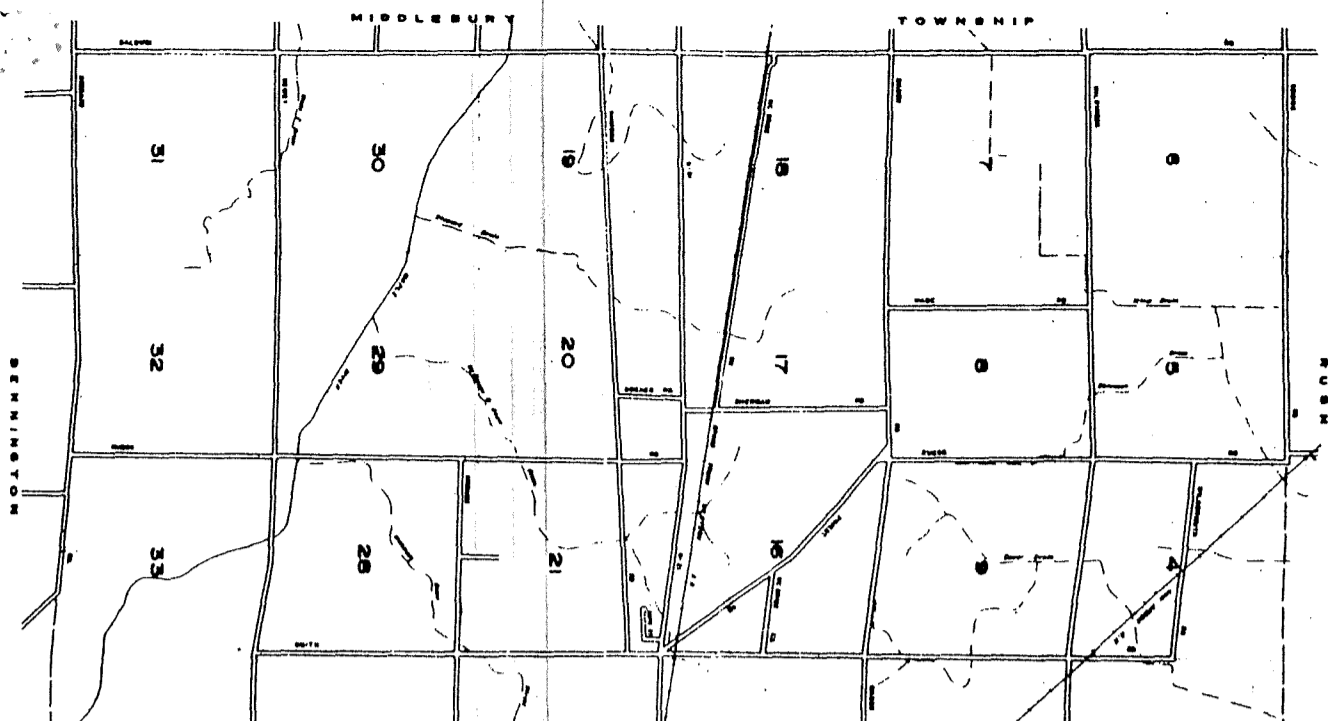

71003
March 4, 1981

PERCENTAGE OF DESIGN FLOW
FOR SHARED SEWER

<u>Point</u>		<u>Owosso Township</u>	<u>Municipality</u>	
<u>From</u>	<u>To</u>		<u>Caledonia Township</u>	<u>City of Corunna</u>
<u>OWOSSO TOWNSHIP</u>				
A	B	46%	35%	19%
B	C	22%	50%	28%
C	D	8%	59%	33%
<u>CALEDONIA TOWNSHIP</u>				
D	E		64%	36%
E	F		64%	36%
F	G	Force Main	64%	36%
G	F	Sanitary Sewer	27%	73%
F	J		27%	73%
H	I	Sanitary Sewer	64%	36%
H	I	Force Main	64%	36%
I	J	Sanitary Sewer	50%	50%
I	J	Force Main	64%	36%
I	K		64%	36%

POINT

LOCATION

A	Chippewa Trail, at Wastewater Treatment Plant
B	Chippewa Trail, 113' North of Laura Lane
C	Curwood Road at Chinook Road
D	Hickory Road at Middleton Road
E	Hintz Road, 3500' South of Middleton Road
F	Hintz Road at Highway M-21
G	Hintz Road, extended South to Pumping Station #8
H	State Road at Pumping Station #7
I	State Road, 240' South of Pumping Station #7
J	Highway M-21, 1350' West of State Road
K	Highway M-21 at Sylvia Drive

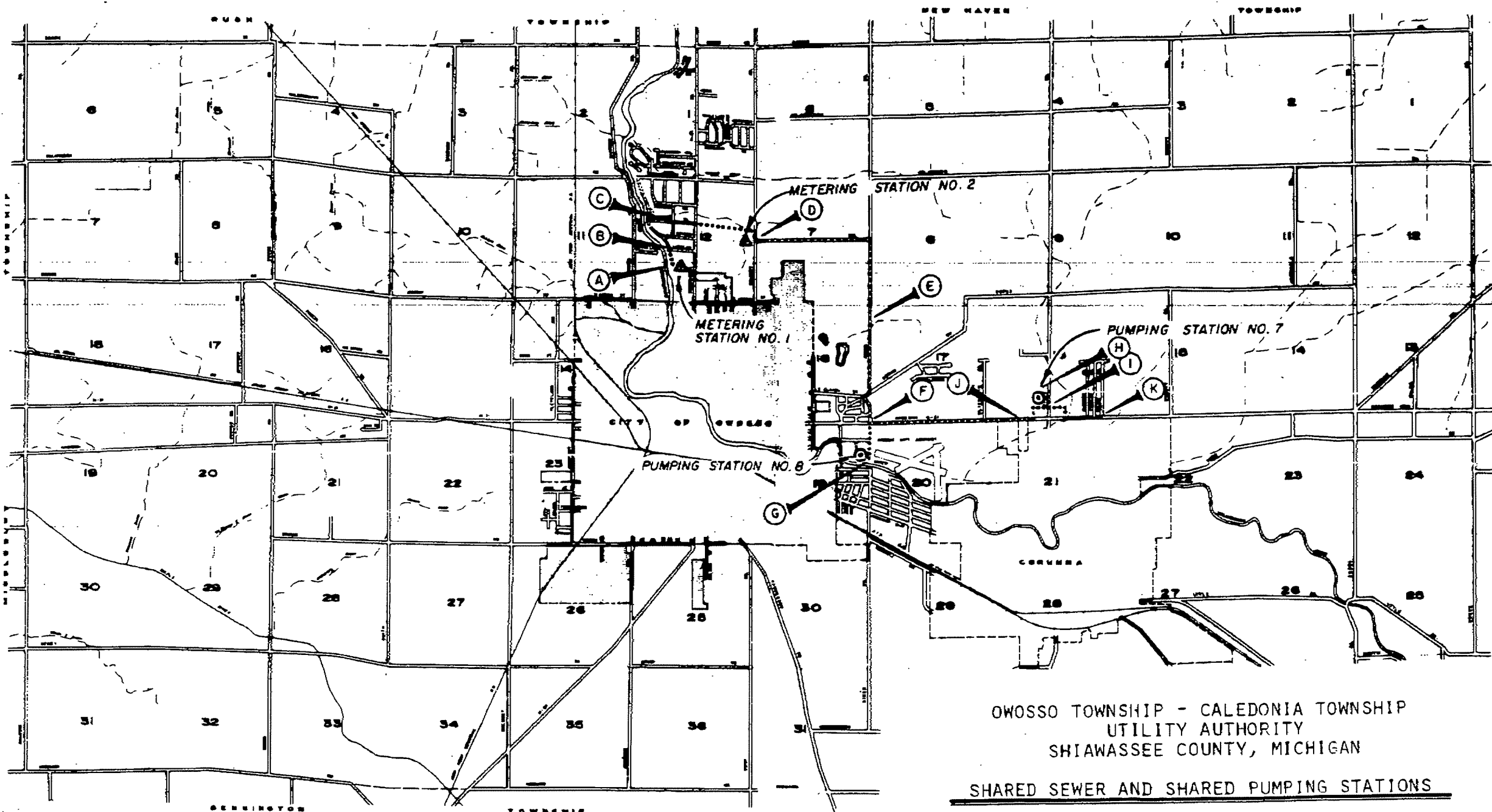

EXHIBIT "C"

OWOSSO TOWNSHIP - CALEDONIA TOWNSHIP
 UTILITY AUTHORITY
 SHIAWASSEE COUNTY, MICHIGAN

SHARED SEWER AND SHARED PUMPING STATIONS

- ⊙ SHARED PUMPING STATIONS
- ▲ SHARED METERING STATIONS

PREIN & NEWHOF, P.C.
 ENGINEERS - PLANNERS
 GRAND RAPIDS, MICHIGAN 49505