

REVISIONS		
DATE	L.S. NAME	L.I.C. NUMBER
10-24-98	KENNETH R FRANK	L.S. 36727
5-2012	CRAG F. REMINGTON	L.S. 23924
8-2015	CHARLES E. ADAMSON	L.S. 42827
3-2017	DIXON ASSOCIATES/ THOMAS A. PRINDENGRIST	L.S. 37604

TAX MAP
TOWNSHIP OF HAMILTON
 ATLANTIC COUNTY, NEW JERSEY
 SCALE: 1" = 400' DATE: JUNE 1, 1977

RONALD J. PRICE
 PLEASANTVILLE, N.J.
 N.J. LICENSE NO. 15901

NEW JERSEY DEPARTMENT OF THE TREASURY
 DIVISION OF TAXATION
 LOCAL PROPERTY AND PUBLIC UTILITY BRANCH
 APPROVED AS A TAX MAP PURSUANT TO THE
 PROVISIONS OF CHAPTER 175, LAWS OF 1913, ETC.
 FOR THE DIRECTOR, DIVISION OF TAXATION
 BY: *[Signature]* P.E. & L.S.
 DATE: 11/15/15 SERIAL NO. 573

NEW JERSEY DEPARTMENT OF THE TREASURY
 DIVISION OF TAXATION
 LOCAL PROPERTY AND PUBLIC UTILITY BRANCH
 APPROVED AS A TAX MAP PURSUANT TO THE
 PROVISIONS OF CHAPTER 175, LAWS OF 1913, ETC.
 FOR THE DIRECTOR, DIVISION OF TAXATION
 BY: *[Signature]* P.E. & L.S.
 DATE: JAN 22 1985 SERIAL NO. 854

ATLANTIC COUNTY
 BUENA VISTA TOWNSHIP

NOTE: LETTERS "LI" INDICATE NUMBERS ON MAP OF INDUSTRIAL LAND COMPANY.
 LETTER "W" INDICATES NUMBER ON MAP OF WEYMOUTH FARM & AGRICULTURAL COMPANY
 * EXEMPT TOWNSHIP OF HAMILTON

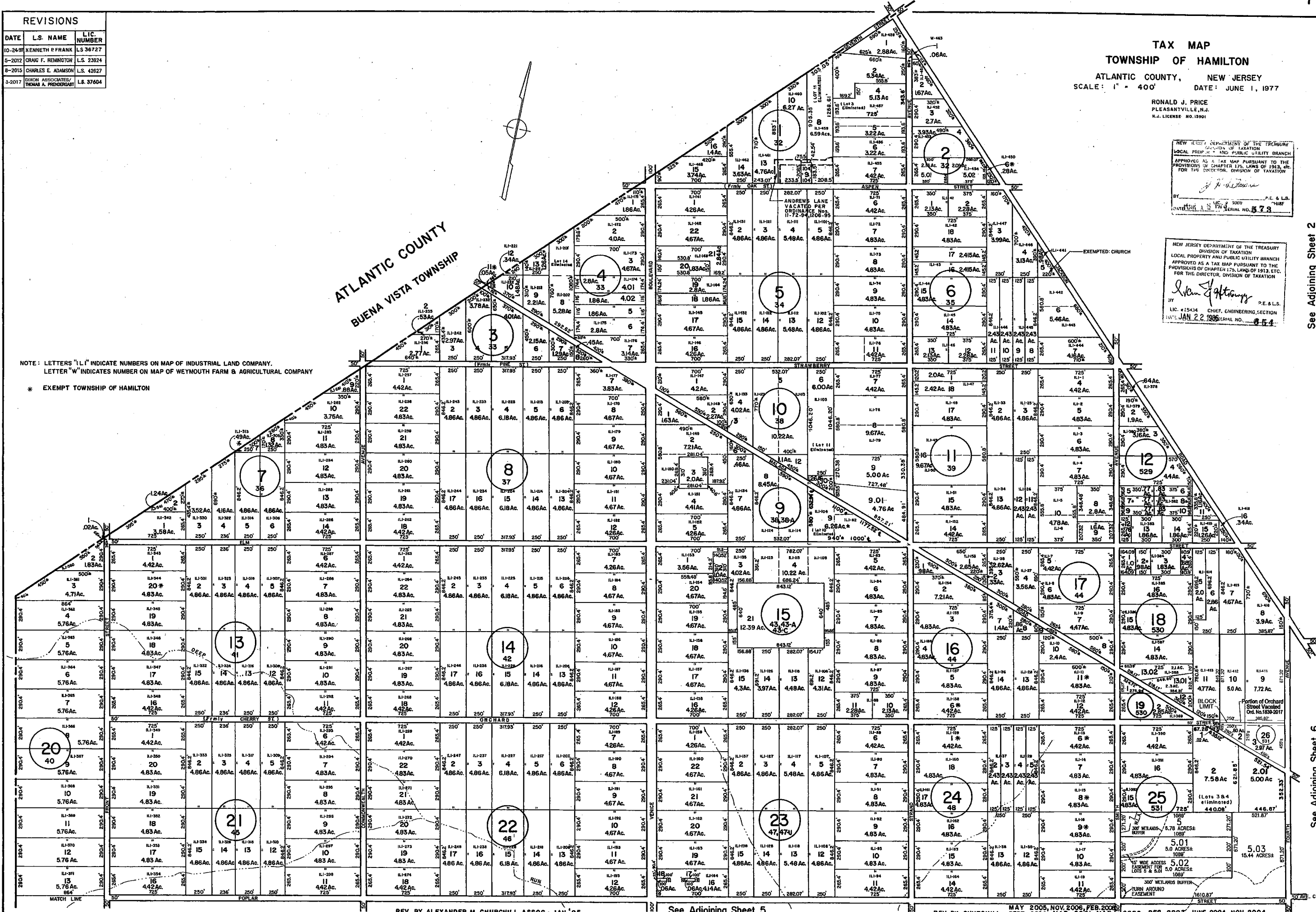

See Adjoining Sheet 2

See Adjoining Sheet 6