

See Adjoining Sheet 14.10

REVISIONS		
DATE	NAME	NO.
8-10-2015	CHARLES E. ADAMSON	42627
3-2017	DIXON ASSOCIATES/ THOMAS A. PRENDERGAST	LS. 37604

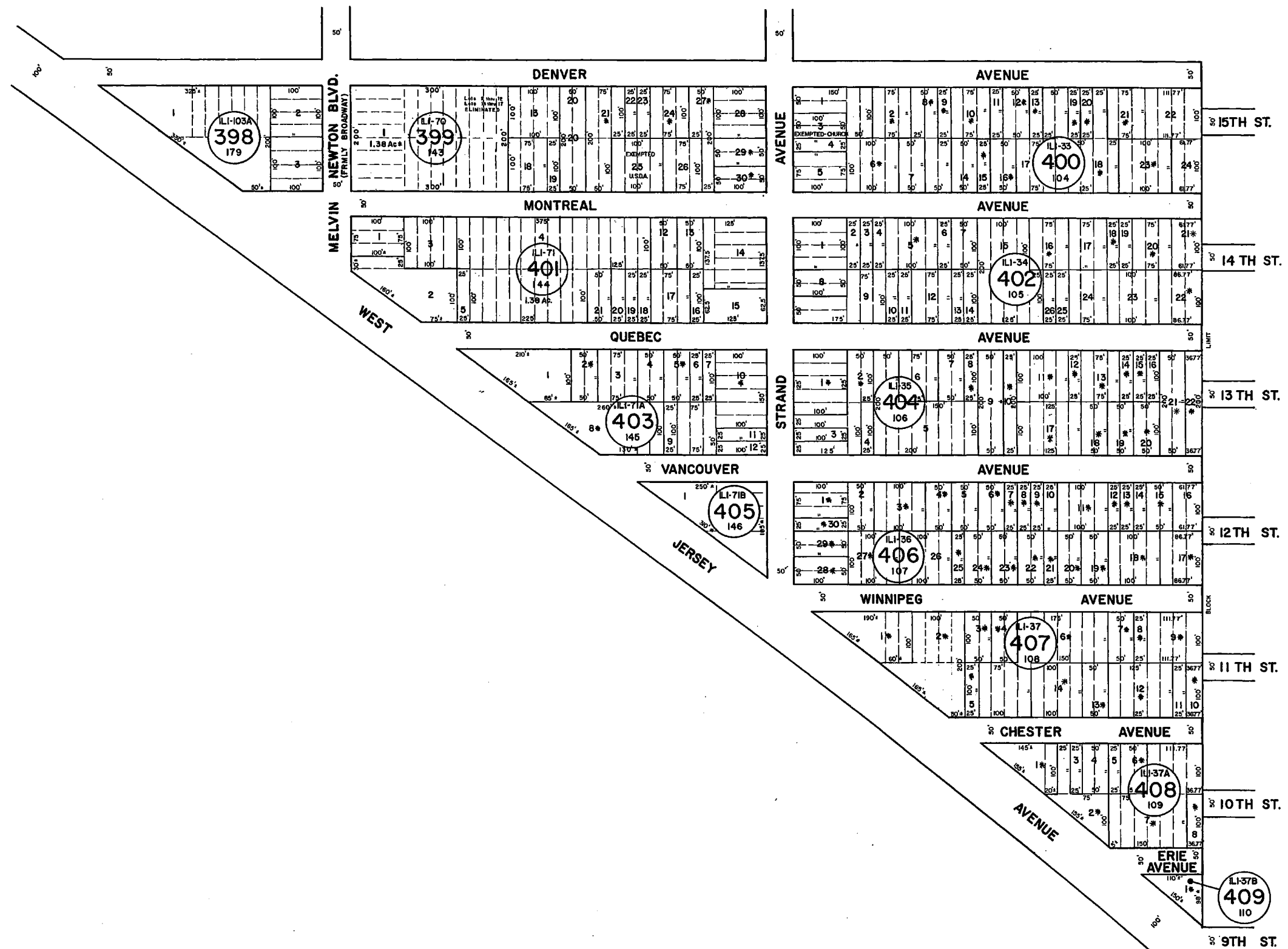

See Adjoining Sheet 14

* EXEMPT TOWNSHIP OF HAMILTON
 NOTE: LETTERS "ILL" INDICATES NUMBER ON MAP OF INDUSTRIAL LAND COMPANY.

See Adjoining Sheet 16

NEW JERSEY DEPARTMENT OF THE TREASURY
 DIVISION OF TAXATION
 LOCAL PROPERTY AND PUBLIC UTILITY BRANCH
 APPROVED AS A TAX MAP PURSUANT TO THE
 PROVISIONS OF CHAPTER 175, LAWS OF 1913, ETC.
 FOR THE DIRECTOR, DIVISION OF TAXATION

Alexander M. Churchill
 BY: _____ P.E. & L.S.
 LIC. #15434 CHIEF, ENGINEERING SECTION
 DATE: JAN 22 1986 SERIAL NO. 654

NEW JERSEY DEPARTMENT OF THE TREASURY
 DIVISION OF TAXATION
 LOCAL PROPERTY AND PUBLIC UTILITY BRANCH
 APPROVED AS A TAX MAP PURSUANT TO THE
 PROVISIONS OF CHAPTER 175, LAWS OF 1913, ETC.
 FOR THE DIRECTOR, DIVISION OF TAXATION

Ronald J. Price
 BY: _____ P.E. & L.S.
 LIC. # 5009
 DATE: JAN 18 1986 SERIAL NO. 73

TAX MAP
 TOWNSHIP OF HAMILTON
 ATLANTIC COUNTY, NEW JERSEY
 SCALE: 1" = 100' DATE: JUNE 1, 1977

RONALD J. PRICE
 PLEASANTVILLE, N.J.
 N.J. LICENSE NO. 12801

REV. BY ALEXANDER M. CHURCHILL ASSOC. - JAN. '95, SEPT. 2007

REV. BY REMINGTON & VERNICK ENGINEERS - 1-8-2013
REVISED BY CHURCHILL - JULY 2005, FEB. 2008