

ATLANTIC COUNTY

BUENA VISTA TOWNSHIP

See Adjoining Sheet 5

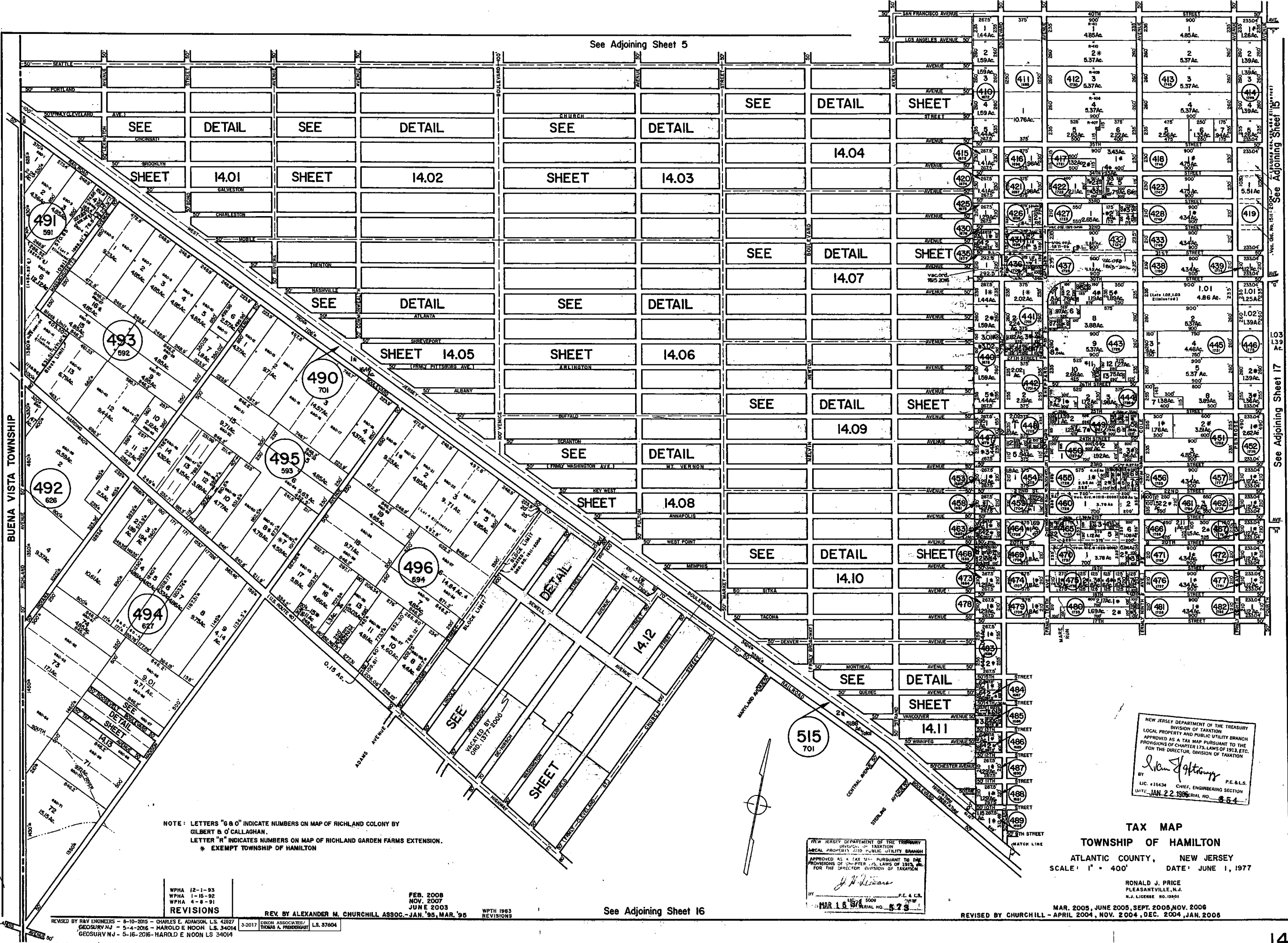

NOTE: LETTERS "G & O" INDICATE NUMBERS ON MAP OF RICHLAND COLONY BY GILBERT & O'CALLAGHAN.  
 LETTER "R" INDICATES NUMBERS ON MAP OF RICHLAND GARDEN FARMS EXTENSION.  
 \* EXEMPT TOWNSHIP OF HAMILTON

WPMA 12-1-93  
 WPMA 1-10-92  
 WPMA 4-8-91  
**REVISIONS**

REV. BY ALEXANDER M. CHURCHILL ASSOC. - JAN. '95, MAR. '95  
 FEB. 2008  
 NOV. 2007  
 JUNE 2003  
 WPTH 1983 REVISIONS

REVISED BY RAY ENGINEERS - 8-10-2015 - CHARLES E. ADAMSON, L.S. 42927  
 GEOSURV N.J. - 5-14-2016 - HAROLD E. NOON, L.S. 34014  
 GEOSURV N.J. - 5-16-2016 - HAROLD E. NOON, L.S. 34014

See Adjoining Sheet 16

NEW JERSEY DEPARTMENT OF THE TREASURY  
 DIVISION OF TAXATION  
 LOCAL PROPERTY AND PUBLIC UTILITY BRANCH  
 APPROVED AS A TAX MAP PURSUANT TO THE PROVISIONS OF CHAPTER 175, LAWS OF 1913, ETC. FOR THE DIRECTOR, DIVISION OF TAXATION  
 J. N. [Signature]  
 P.E. & L.S.  
 MAR 16 2009 SERIAL NO. 873

NEW JERSEY DEPARTMENT OF THE TREASURY  
 DIVISION OF TAXATION  
 LOCAL PROPERTY AND PUBLIC UTILITY BRANCH  
 APPROVED AS A TAX MAP PURSUANT TO THE PROVISIONS OF CHAPTER 175, LAWS OF 1913, ETC. FOR THE DIRECTOR, DIVISION OF TAXATION  
 [Signature]  
 P.E. & L.S.  
 LIC. #15434  
 CHIEF, ENGINEERING SECTION  
 DATE: JAN. 22 1998 SERIAL NO. 454

**TAX MAP**  
**TOWNSHIP OF HAMILTON**  
 ATLANTIC COUNTY, NEW JERSEY  
 SCALE: 1" = 400' DATE: JUNE 1, 1977

RONALD J. PRICE  
 PLEASANTVILLE, N.J.  
 N.J. LICENSE 90-19301  
 MAR. 2005, JUNE 2005, SEPT. 2006, NOV. 2006  
 REVISED BY CHURCHILL - APRIL 2004, NOV. 2004, DEC. 2004, JAN. 2006