

REVISIONS
WPHA 7-23-92
WPHA 7-18-96

See Adjoining Sheet 16

REVISIONS		
DATE	L.S. NAME	LIC. No
	KENNETH P FRANK	LS 36727
1-8-2013	CRAIG F REMINGTON	LS 23924
10-4-2013	CRAIG F REMINGTON	LS 23924
4-3-2014	CHARLES E ADAMSON	LS 42627
3-2017	DIXON ASSOCIATES/ THOMAS A. FREUDENBERG	LS 37604

NOTE THE APPARENT CORNER LINES & DIMENSIONS SHOWN ARE PLOTTED IN ACCORDANCE WITH THE METES & BOUNDS DESCRIPTIONS APPEARING IN THE LAST DEED/FILED PLAN OF RECORD FOR EACH PARCEL/SUBDIVISION & DO NOT PURPORT TO REPRESENT TITLE OR OWNERSHIP STATUS IN ANY MANNER THESE SITUATIONS ARE SUBJECT TO SOLUTION BY THE PROPERTY OWNERS CONCERNED OWNERSHIP UNKNOWN

NOTE LETTERS "G&O" INDICATE NUMBERS ON MAP OF RICHLAND COLONY BY GILBERT & O'CALLAGHAN

ATLANTIC COUNTY
BUENA VISTA TOWNSHIP

See Adjoining Sheet 23

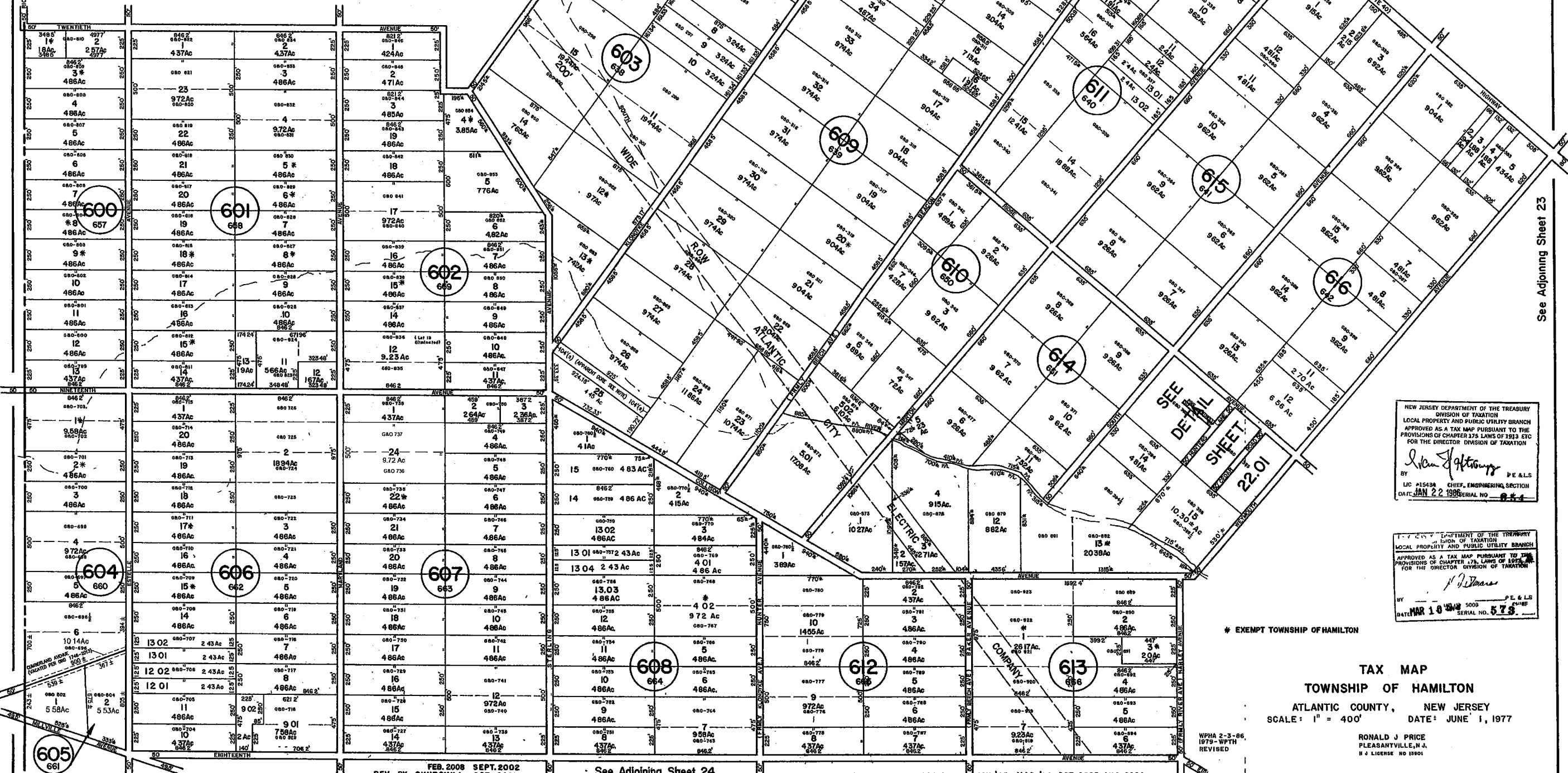

NEW JERSEY DEPARTMENT OF THE TREASURY
DIVISION OF TAXATION
LOCAL PROPERTY AND PUBLIC UTILITY BRANCH
APPROVED AS A TAX MAP PURSUANT TO THE
PROVISIONS OF CHAPTER 175, LAWS OF 1953, ETC.
FOR THE DIRECTOR, DIVISION OF TAXATION

Alexander M. Churchill P.E. & L.S.
LIC #15438 CHIEF, ENGINEERING SECTION
DATE: JAN 22 1986 SERIAL NO. 854

NEW JERSEY DEPARTMENT OF THE TREASURY
DIVISION OF TAXATION
LOCAL PROPERTY AND PUBLIC UTILITY BRANCH
APPROVED AS A TAX MAP PURSUANT TO THE
PROVISIONS OF CHAPTER 175, LAWS OF 1953, ETC.
FOR THE DIRECTOR, DIVISION OF TAXATION

Ronald J. Price P.E. & L.S.
MAR 10 2008 5009 P-HEP
DATE: MAR 10 2008 SERIAL NO. 573

EXEMPT TOWNSHIP OF HAMILTON

TAX MAP
TOWNSHIP OF HAMILTON
ATLANTIC COUNTY, NEW JERSEY
SCALE: 1" = 400' DATE: JUNE 1, 1977

WPHA 2-3-96,
1979-WPTH
REVISED

RONALD J PRICE
PLEASANTVILLE, N.J.
N.J. LICENSE NO 19001

FEB. 2008 SEPT. 2002
REV. BY CHURCHILL - OCT. 2001

See Adjoining Sheet 24

REV. BY ALEXANDER M. CHURCHILL ASSOC - JAN. '95, MAR '95, OCT 2005, AUG. 2006