

REVISIONS		
DATE	NAME	NO.
3-2017	DIXON ASSOCIATES/ THOMAS A. PRIEDERHART	L.S. 37604

See Adjoining Sheet 22

See Adjoining Sheet 16

See Adjoining Sheet 17

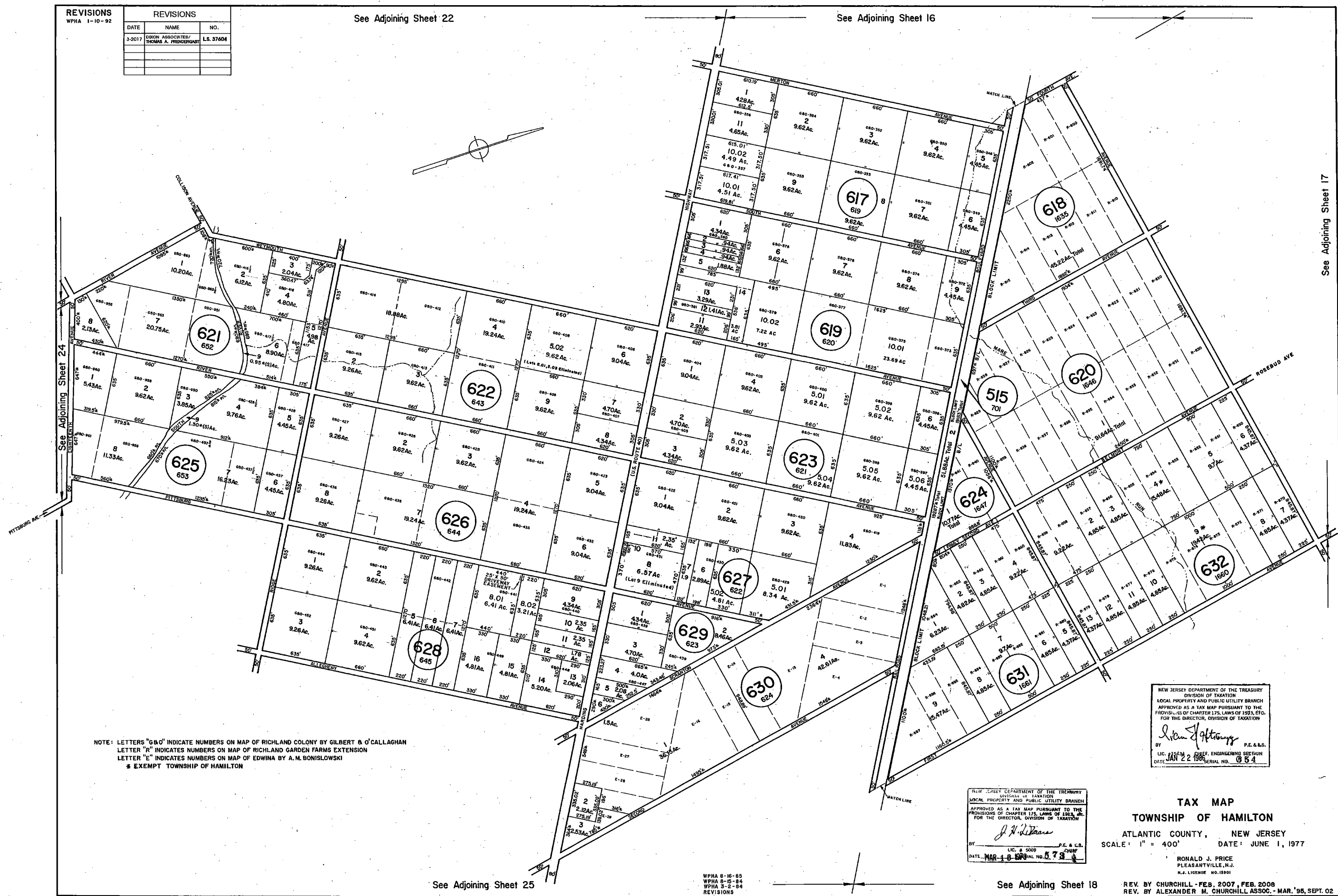

NOTE: LETTERS "G&O" INDICATE NUMBERS ON MAP OF RICHLAND COLONY BY GILBERT & O'CALLAGHAN
 LETTER "R" INDICATES NUMBERS ON MAP OF RICHLAND GARDEN FARMS EXTENSION
 LETTER "E" INDICATES NUMBERS ON MAP OF EDWINA BY A. M. BONISLOWSKI
 * EXEMPT TOWNSHIP OF HAMILTON

NEW JERSEY DEPARTMENT OF THE TREASURY
 DIVISION OF TAXATION
 LOCAL PROPERTY AND PUBLIC UTILITY BRANCH
 APPROVED AS A TAX MAP PURSUANT TO THE
 PROVISIONS OF CHAPTER 175, LAWS OF 1973, ETC.
 FOR THE DIRECTOR, DIVISION OF TAXATION
John J. Hoffmann
 BY LIC. # 21734 P.E. & L.S.
 DATE: JAN 22 1980 SERIAL NO. 654

NEW JERSEY DEPARTMENT OF THE TREASURY
 DIVISION OF TAXATION
 LOCAL PROPERTY AND PUBLIC UTILITY BRANCH
 APPROVED AS A TAX MAP PURSUANT TO THE
 PROVISIONS OF CHAPTER 175, LAWS OF 1973, ETC.
 FOR THE DIRECTOR, DIVISION OF TAXATION
J. N. Williams
 BY LIC. # 5009 P.E. & L.S.
 DATE: MAR 18 1978 SERIAL NO. 578

TAX MAP
TOWNSHIP OF HAMILTON
 ATLANTIC COUNTY, NEW JERSEY
 SCALE: 1" = 400' DATE: JUNE 1, 1977
 RONALD J. PRICE
 PLEASANTVILLE, N.J.
 N.J. LICENSE NO. 18901
 REV. BY CHURCHILL - FEB. 2007, FEB. 2008
 REV. BY ALEXANDER M. CHURCHILL ASSOC. - MAR. '98, SEPT. 02

See Adjoining Sheet 25

WPHA 8-16-85
 WPHA 8-15-84
 WPHA 3-2-84
 REVISIONS

See Adjoining Sheet 18