

See Adjoining Sheet 27

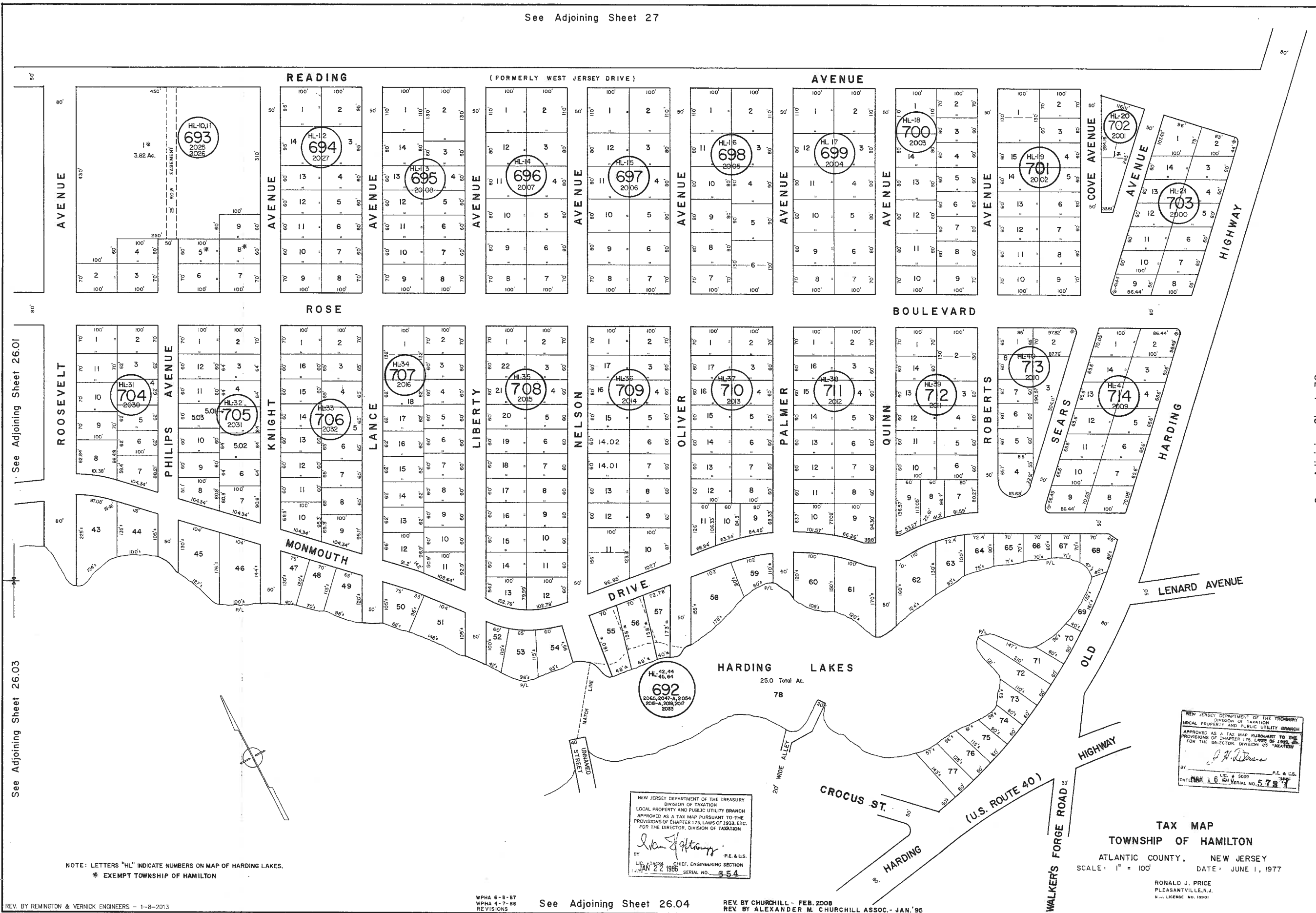

See Adjoining Sheet 26.01

See Adjoining Sheet 26.03

See Adjoining Sheet 30

NOTE: LETTERS "HL" INDICATE NUMBERS ON MAP OF HARDING LAKES.
 * EXEMPT TOWNSHIP OF HAMILTON

NEW JERSEY DEPARTMENT OF THE TREASURY
 DIVISION OF TAXATION
 LOCAL PROPERTY AND PUBLIC UTILITY BRANCH
 APPROVED AS A TAX MAP PURSUANT TO THE
 PROVISIONS OF CHAPTER 175, LAWS OF 1913, ETC.
 FOR THE DIRECTOR, DIVISION OF TAXATION
 BY: *[Signature]* P.E. & L.S.
 LIC. #15434 CHIEF, ENGINEERING SECTION
 JAN 22 1986 SERIAL NO. 554

NEW JERSEY DEPARTMENT OF THE TREASURY
 DIVISION OF TAXATION
 LOCAL PROPERTY AND PUBLIC UTILITY BRANCH
 APPROVED AS A TAX MAP PURSUANT TO THE
 PROVISIONS OF CHAPTER 175, LAWS OF 1913, ETC.
 FOR THE DIRECTOR, DIVISION OF TAXATION
 BY: *[Signature]* P.E. & L.S.
 LIC. # 5009 SERIAL NO. 578

TAX MAP
 TOWNSHIP OF HAMILTON
 ATLANTIC COUNTY, NEW JERSEY
 SCALE: 1" = 100' DATE: JUNE 1, 1977
 RONALD J. PRICE
 PLEASANTVILLE, N.J.
 N.J. LICENSE NO. 15901