

REVISIONS
WPHA 12-13-88

See Adjoining Sheet 28

See Adjoining Sheet 18

See Adjoining Sheet 28

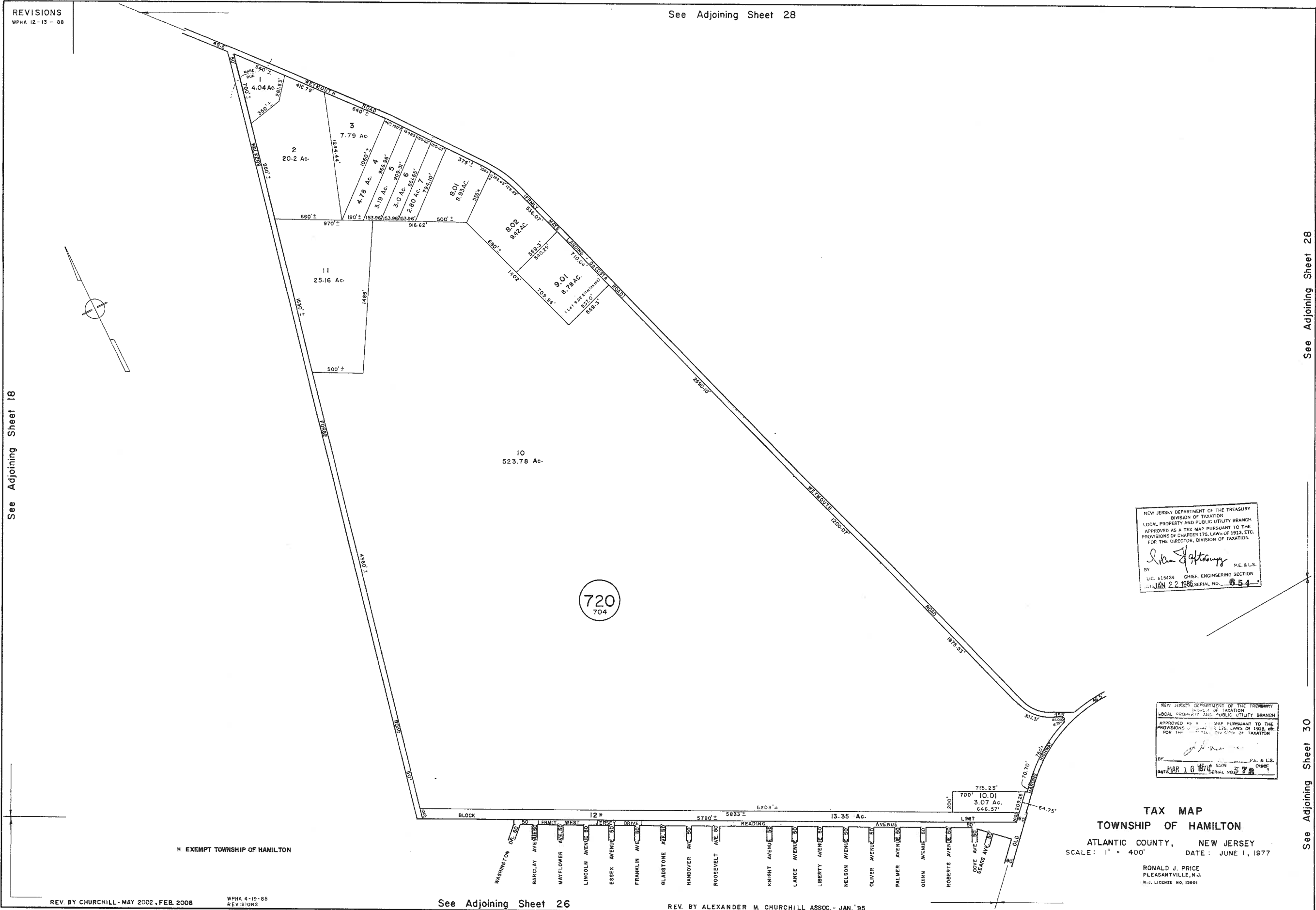
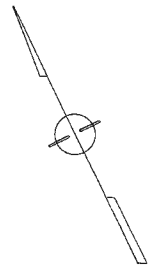

* EXEMPT TOWNSHIP OF HAMILTON

REV. BY CHURCHILL - MAY 2002, FEB. 2008

WPHA 4-10-85
REVISIONS

See Adjoining Sheet 26

REV. BY ALEXANDER M. CHURCHILL ASSOC. - JAN '95

NEW JERSEY DEPARTMENT OF THE TREASURY
DIVISION OF TAXATION
LOCAL PROPERTY AND PUBLIC UTILITY BRANCH
APPROVED AS A TAX MAP PURSUANT TO THE
PROVISIONS OF CHAPTER 175, LAWS OF 1953, ETC.
FOR THE DIRECTOR, DIVISION OF TAXATION
[Signature] P.E. & L.S.
BY LIC. #15434 CHIEF, ENGINEERING SECTION
JAN 22 1988 SERIAL NO. 054

NEW JERSEY DEPARTMENT OF THE TREASURY
DIVISION OF TAXATION
LOCAL PROPERTY AND PUBLIC UTILITY BRANCH
APPROVED AS A TAX MAP PURSUANT TO THE
PROVISIONS OF CHAPTER 175, LAWS OF 1953, ETC.
FOR THE DIRECTOR, DIVISION OF TAXATION
[Signature] P.E. & L.S.
BY LIC. #15434 CHIEF, ENGINEERING SECTION
MAY 10 1977 SERIAL NO. 288

TAX MAP
TOWNSHIP OF HAMILTON
ATLANTIC COUNTY, NEW JERSEY
SCALE: 1" = 400' DATE: JUNE 1, 1977

RONALD J. PRICE
PLEASANTVILLE, N.J.
N.J. LICENSE NO. 13901

See Adjoining Sheet 30