

REVISIONS
WPHA 5-26-89
WPHA 4-30-96

See Adjoining Sheet 29

See Adjoining Sheet 31

See Adjoining Sheet 29

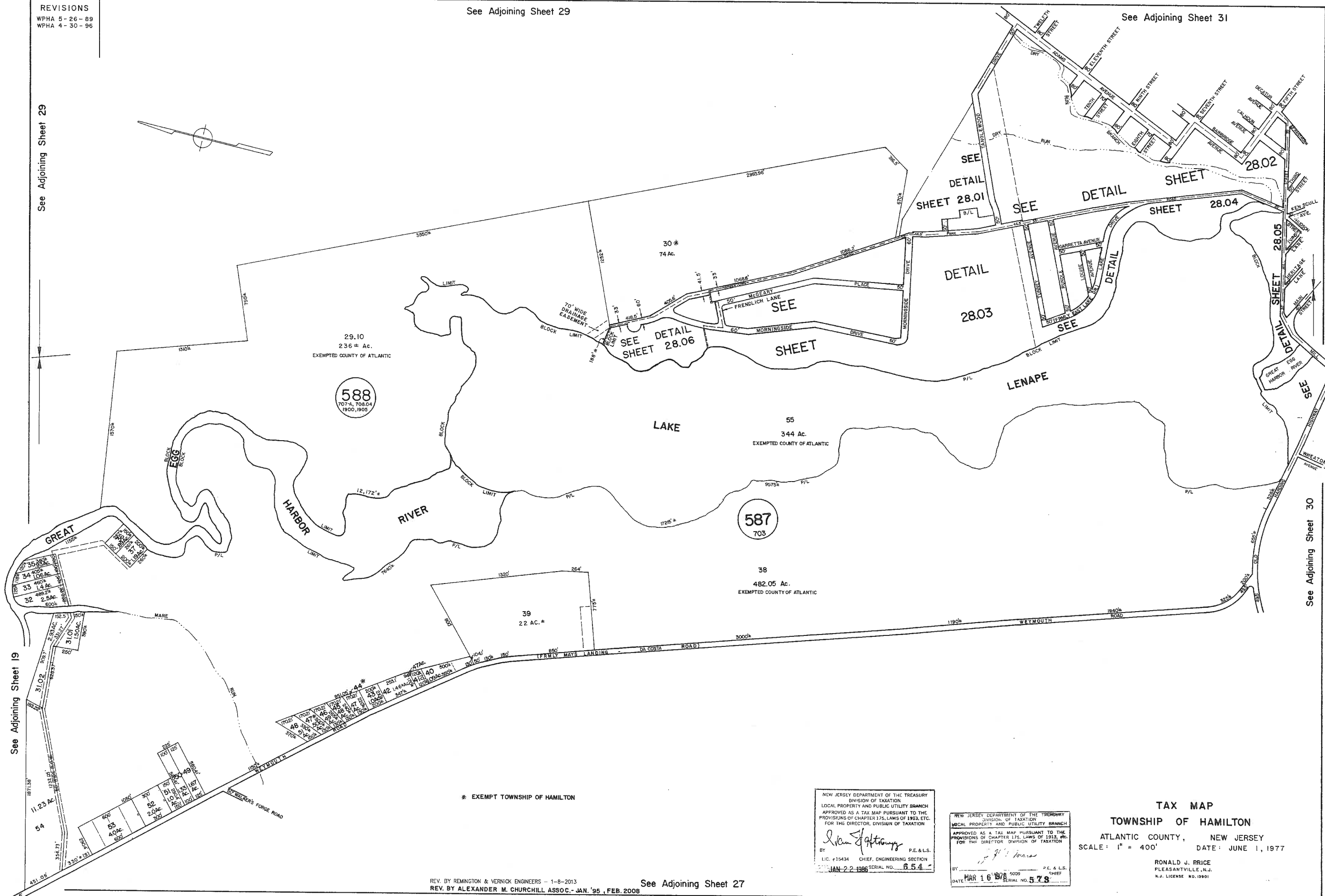
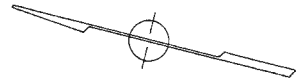

See Adjoining Sheet 19

See Adjoining Sheet 30

* EXEMPT TOWNSHIP OF HAMILTON

REV. BY REMINGTON & VERNICK ENGINEERS - 1-8-2013
REV. BY ALEXANDER M. CHURCHILL ASSOC. - JAN '95, FEB. 2008

See Adjoining Sheet 27

NEW JERSEY DEPARTMENT OF THE TREASURY
DIVISION OF TAXATION
LOCAL PROPERTY AND PUBLIC UTILITY BRANCH
APPROVED AS A TAX MAP PURSUANT TO THE
PROVISIONS OF CHAPTER 175, LAWS OF 1913, ETC.
FOR THE DIRECTOR, DIVISION OF TAXATION
[Signature]
BY P.E. & L.S.
LIC. #15434 CHIEF, ENGINEERING SECTION
JAN 22 1996 SERIAL NO. 854

NEW JERSEY DEPARTMENT OF THE TREASURY
DIVISION OF TAXATION
LOCAL PROPERTY AND PUBLIC UTILITY BRANCH
APPROVED AS A TAX MAP PURSUANT TO THE
PROVISIONS OF CHAPTER 175, LAWS OF 1913, ETC.
FOR THE DIRECTOR, DIVISION OF TAXATION
[Signature]
BY P.E. & L.S.
DATE MAR 16 1978 SERIAL NO. 578

TAX MAP
TOWNSHIP OF HAMILTON
ATLANTIC COUNTY, NEW JERSEY
SCALE: 1" = 400' DATE: JUNE 1, 1977

RONALD J. PRICE
PLEASANTVILLE, N.J.
N.J. LICENSE NO. 13901