

See Adjoining Sheet 38

See Adjoining Sheet 31.05

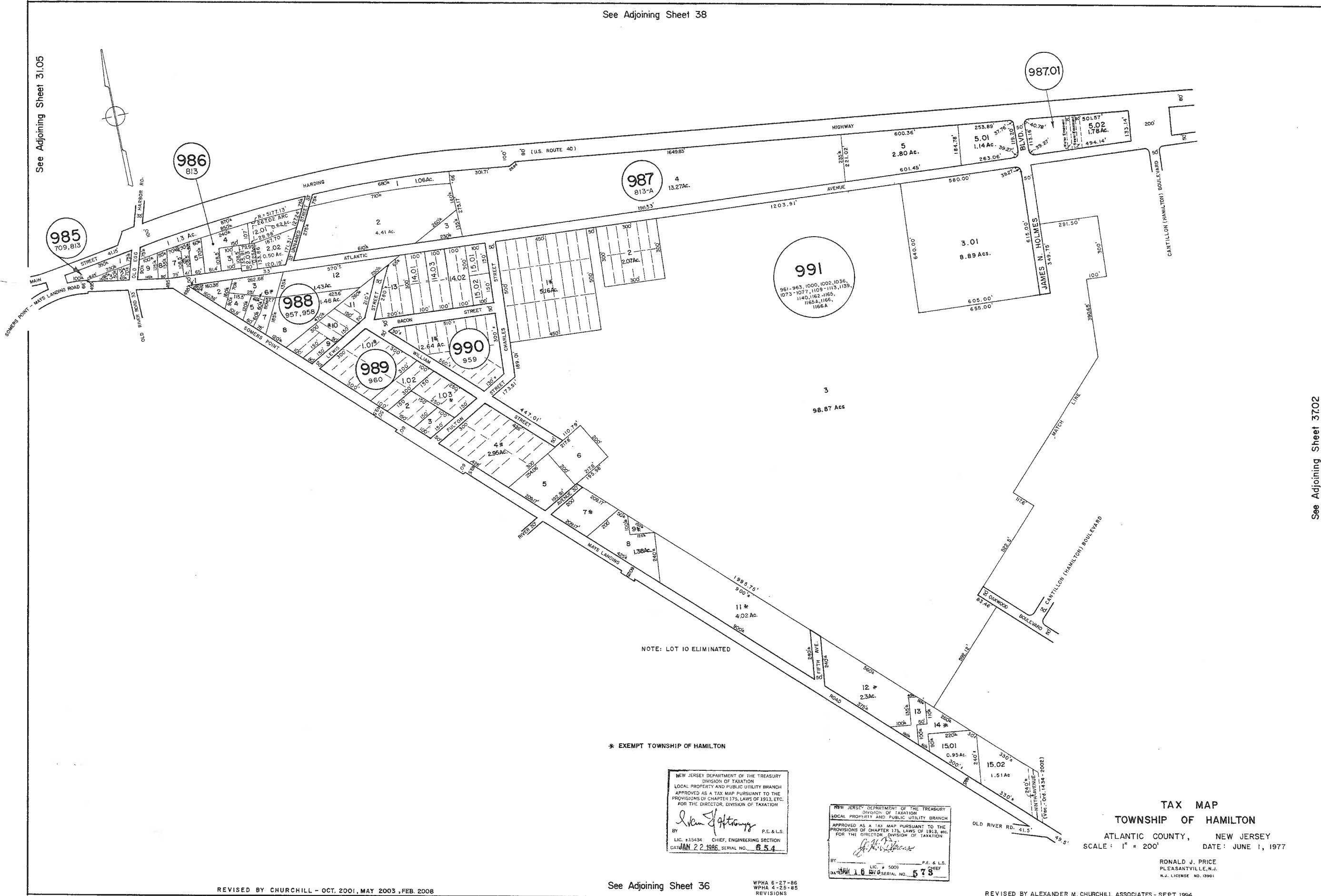

NOTE: LOT 10 ELIMINATED

\* EXEMPT TOWNSHIP OF HAMILTON

NEW JERSEY DEPARTMENT OF THE TREASURY  
 DIVISION OF TAXATION  
 LOCAL PROPERTY AND PUBLIC UTILITY BRANCH  
 APPROVED AS A TAX MAP PURSUANT TO THE  
 PROVISIONS OF CHAPTER 175, LAWS OF 1913, ETC.  
 FOR THE DIRECTOR, DIVISION OF TAXATION

*John J. Anthony*  
 BY: P.E. & L.S.  
 LIC. #15434 CHIEF, ENGINEERING SECTION  
 DATE: JAN 22 1996 SERIAL NO. 854

NEW JERSEY DEPARTMENT OF THE TREASURY  
 DIVISION OF TAXATION  
 LOCAL PROPERTY AND PUBLIC UTILITY BRANCH  
 APPROVED AS A TAX MAP PURSUANT TO THE  
 PROVISIONS OF CHAPTER 175, LAWS OF 1913, ETC.  
 FOR THE DIRECTOR, DIVISION OF TAXATION

*John J. Anthony*  
 BY: P.E. & L.S.  
 LIC. # 5002 CHIEF  
 DATE: JAN 16 1996 SERIAL NO. 578

**TAX MAP**  
 TOWNSHIP OF HAMILTON  
 ATLANTIC COUNTY, NEW JERSEY  
 SCALE: 1" = 200'  
 DATE: JUNE 1, 1977

RONALD J. PRICE  
 PLEASANTVILLE, N.J.  
 N.J. LICENSE NO. 19961

REVISED BY CHURCHILL - OCT. 2001, MAY 2003, FEB. 2008

See Adjoining Sheet 36

WPHA 6-27-86  
WPHA 4-25-85  
REVISIONS

REVISED BY ALEXANDER M. CHURCHILL ASSOCIATES - SEPT. 1994

See Adjoining Sheet 37.02