

REVISIONS		
DATE	L.S. NAME	L.I.C. NUMBER
10-24-87	KENNETH R FRANK	L.S. 23827
9-26-82	CRAG F. KENNEDY	L.S. 23824
8-20-85	CHARLES C. ADAMSON	L.S. 42627
2-20-77	DONALD ASSOCIATES, INC. & PARTNERS	L.S. 37800
2-29-81	DONALD ASSOCIATES, INC. & PARTNERS	L.S. 37800
8-13-88	THOMAS PROGRESSIVE	L.S. 37804

TAX MAP
TOWNSHIP OF HAMILTON
ATLANTIC COUNTY, NEW JERSEY
SCALE: 1" = 400' DATE: JUNE 1, 1977

RONALD J. PRICE
PLEASANTVILLE, N.J.
N.J. LICENSE NO. 11507

NEW JERSEY DEPARTMENT OF TREASURY
DIVISION OF TAXATION
APPROVED AS A TAX MAP PURSUANT TO THE
PROVISIONS OF CHAPTER 125, LAWS OF 1953, ETC.
FOR THE DISTRICT OF HAMILTON, COUNTY OF HAMILTON

BY: *Ronald J. Price*
DATE: JUN 1 1977 SERIAL NO. 873

NEW JERSEY DEPARTMENT OF TREASURY
DIVISION OF TAXATION
APPROVED AS A TAX MAP PURSUANT TO THE
PROVISIONS OF CHAPTER 125, LAWS OF 1953, ETC.
FOR THE DISTRICT OF HAMILTON, COUNTY OF HAMILTON

BY: *Ronald J. Price*
DATE: JAN 22 1985 SERIAL NO. 874

See Adjoining Sheet 2

ATLANTIC COUNTY
BUENA VISTA TOWNSHIP

NOTE: LETTERS "L" INDICATE NUMBERS ON MAP OF INDUSTRIAL LAND COMPANY.
LETTER "W" INDICATES NUMBER ON MAP OF WEYMOUTH FARM & AGRICULTURAL COMPANY
X EXEMPT TOWNSHIP OF HAMILTON

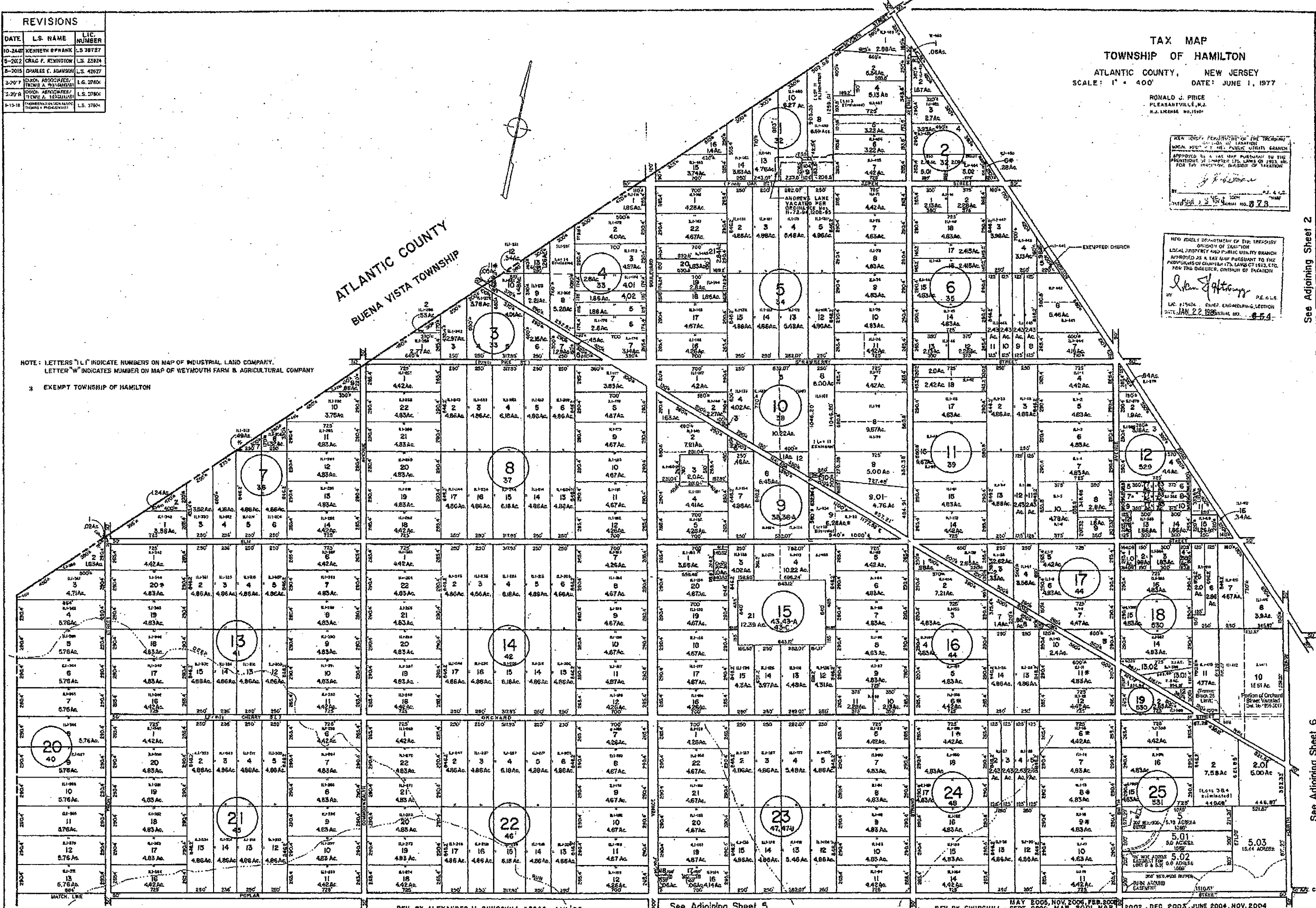

REV. BY ALEXANDER M. CHURCHILL 4590C - JAN '93

See Adjoining Sheet 5

MAY 2005, NOV 2006, FEB 2008
REV. BY CHURCHILL - SEPT. 2000, MAR. 2001 MAR. 2002, DEC. 2003, JUNE 2004, NOV. 2004

See Adjoining Sheet 6