

REVISIONS		
DATE	NAME	NO.
3-2017	DOON ASSOCIATES/ THOMAS A. PRENDERGAST	L.S. 37604
9-13-18	ENGINEERING DESIGN ASSOC THOMAS A. PRENDERGAST	L.S. 37604

ATLANTIC COUNTY  
MULLICA TOWNSHIP

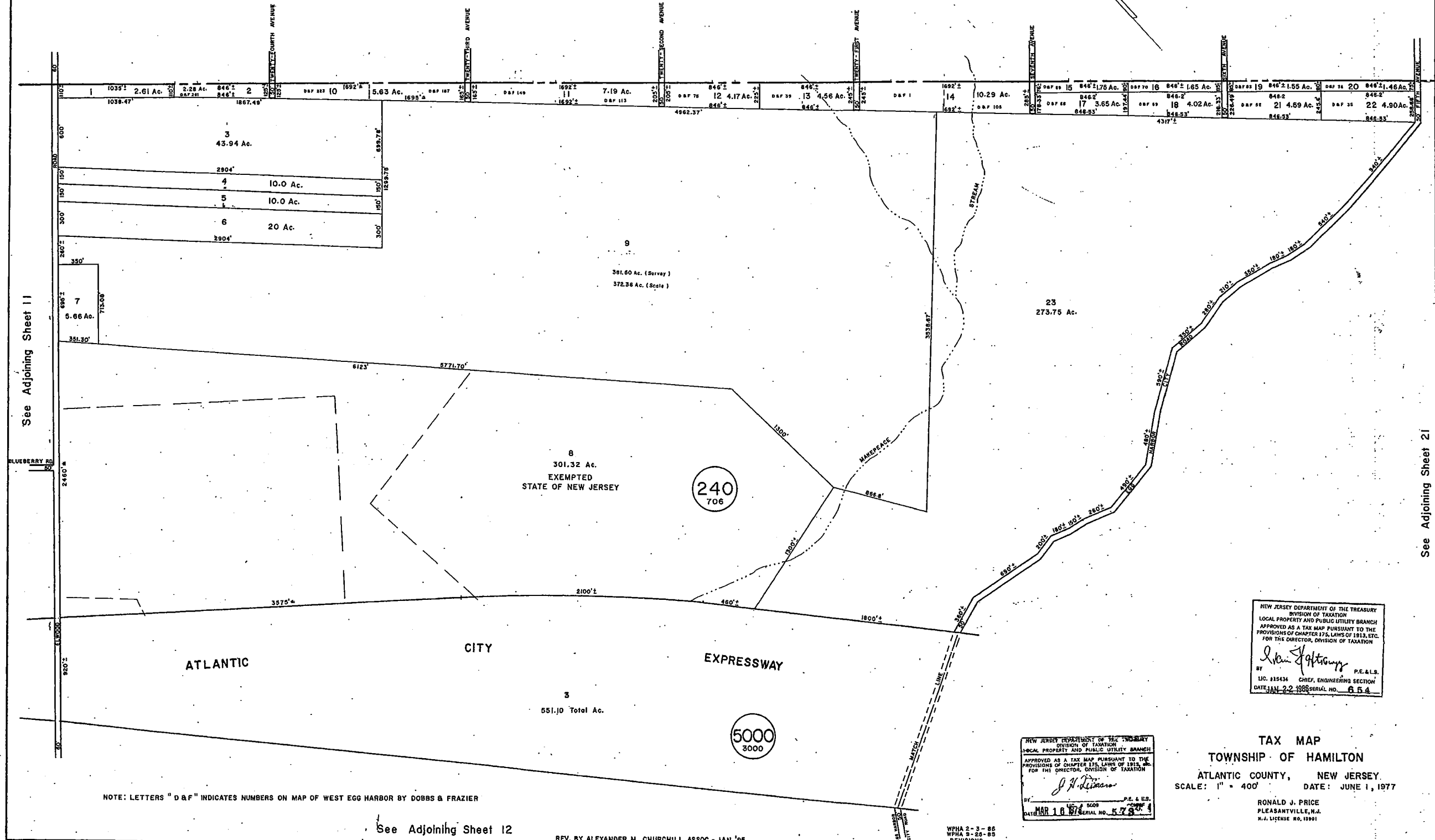

See Adjoining Sheet 11

See Adjoining Sheet 21

NOTE: LETTERS "D & F" INDICATES NUMBERS ON MAP OF WEST EGG HARBOR BY DOBBS & FRAZIER

See Adjoining Sheet 12

REV. BY ALEXANDER N. CHURCHILL ASSOC. - JAN. '95

NEW JERSEY DEPARTMENT OF THE TREASURY  
DIVISION OF TAXATION  
LOCAL PROPERTY AND PUBLIC UTILITY BRANCH  
APPROVED AS A TAX MAP PURSUANT TO THE  
PROVISIONS OF CHAPTER 175, LAWS OF 1913, ETC.  
FOR THE DIRECTOR, DIVISION OF TAXATION  
*J. H. Williams*  
BY: J. H. WILLIAMS, P.E. & L.S.  
LIC. # 5009  
DATE: MAR 18 1977 SERIAL NO. 57804

NEW JERSEY DEPARTMENT OF THE TREASURY  
DIVISION OF TAXATION  
LOCAL PROPERTY AND PUBLIC UTILITY BRANCH  
APPROVED AS A TAX MAP PURSUANT TO THE  
PROVISIONS OF CHAPTER 175, LAWS OF 1913, ETC.  
FOR THE DIRECTOR, DIVISION OF TAXATION  
*John J. Hartung*  
BY: JOHN J. HARTUNG, P.E. & L.S.  
LIC. # 115434 CHIEF, ENGINEERING SECTION  
DATE: JAN 22 1988 SERIAL NO. 654

TAX MAP  
TOWNSHIP OF HAMILTON  
ATLANTIC COUNTY, NEW JERSEY  
SCALE: 1" = 400' DATE: JUNE 1, 1977

RONALD J. PRICE  
PLEASANTVILLE, N.J.  
N.J. LICENSE NO. 19901

WPHA 2-3-88  
WPHA 3-25-88  
REVISIONS