

REVISIONS
WPHA 1-14-82

DATE	NAME	NO.
3-2017	DUDON ASSOCIATES/ THOMAS A. FREEDMAN	L.S. 37604
5-13-18	ALEXANDER M. CHURCHILL ASSOC. CHIEF ENGINEERING	L.S. 37604

See Adjoining Sheet 5.08

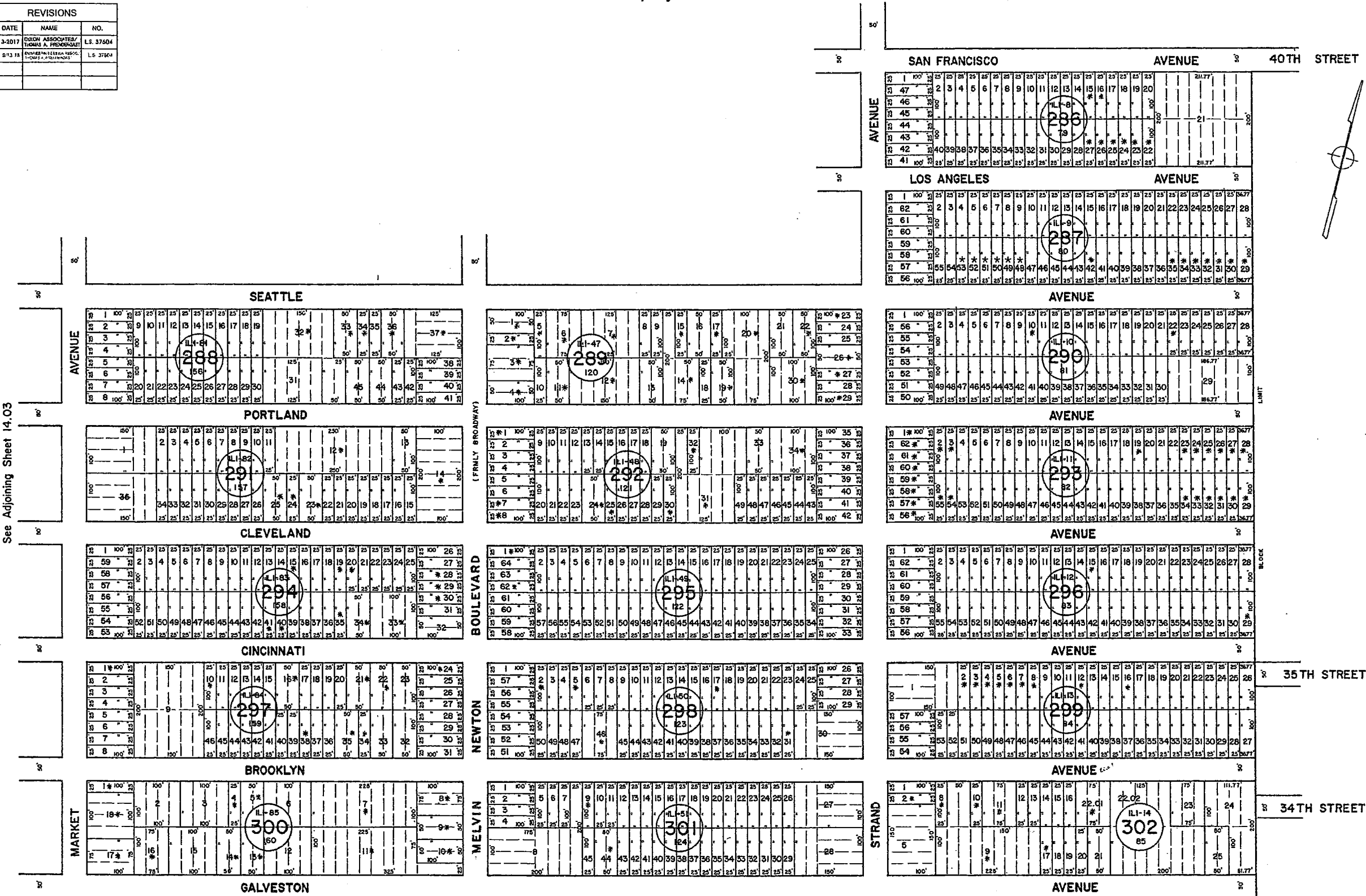

See Adjoining Sheet 14.03

See Adjoining Sheet 14

NOTE: LETTERS "ILI" INDICATE NUMBERS ON MAP OF INDUSTRIAL LAND COMPANY.
* EXEMPT TOWNSHIP OF HAMILTON

REVISED BY R&V - 1-8-2013
REV. BY CHURCHILL - FEB. 2008
REV. BY ALEXANDER M. CHURCHILL ASSOC. - JAN. '95

See Adjoining Sheet 14.07

NEW JERSEY DEPARTMENT OF THE TREASURY
DIVISION OF TAXATION
LOCAL PROPERTY AND PUBLIC UTILITY BRANCH
APPROVED AS A TAX MAP PURSUANT TO THE
PROVISIONS OF CHAPTER 175, LAWS OF 1913, ETC.
FOR THE DIRECTOR, DIVISION OF TAXATION

John J. Anthony
BY: P.E. & L.L.
LIC. #15434 CHIEF ENGINEERING SECTION
DATE: JAN 22 1996 SERIAL NO. 654

NEW JERSEY DEPARTMENT OF THE TREASURY
DIVISION OF TAXATION
LOCAL PROPERTY AND PUBLIC UTILITY BRANCH
APPROVED AS A TAX MAP PURSUANT TO THE
PROVISIONS OF CHAPTER 175, LAWS OF 1913, ETC.
FOR THE DIRECTOR, DIVISION OF TAXATION

J. P. Williams
BY: P.E. & L.L.
LIC. # 5009
DATE: MAR 16 1996 SERIAL NO. 5787

TAX MAP
TOWNSHIP OF HAMILTON
ATLANTIC COUNTY, NEW JERSEY
SCALE: 1" = 100'
DATE: JUNE 1, 1977

RONALD J. PRICE
PLEASANTVILLE, N.J.
P.L. LICENSE NO. 18061