

See Adjoining Sheet 14.10

REVISIONS		
DATE	NAME	NO.
8-10-2015	CHARLES E. ADAMSON	42627
3-2017	DIXON ASSOCIATES/ THOMAS A. FRENDEBERGAST	L.S. 37604
11-2017	DIXON ASSOCIATES/ THOMAS A. FRENDEBERGAST	L.S. 37604
9-15-18	DIXON ASSOCIATES/ THOMAS A. FRENDEBERGAST	L.S. 37604

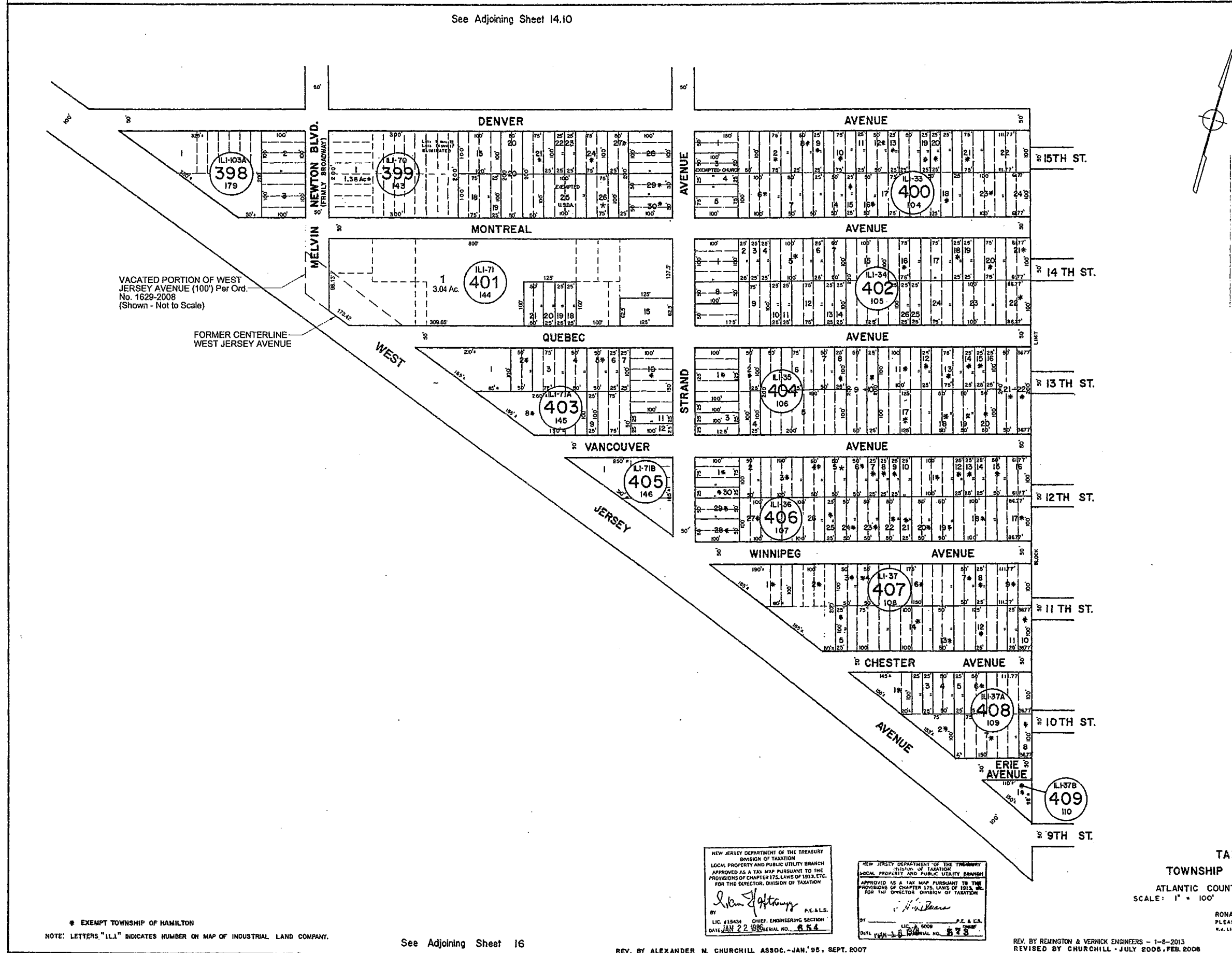

VACATED PORTION OF WEST JERSEY AVENUE (100') Per Ord. No. 1629-2008 (Shown - Not to Scale)

FORMER CENTERLINE WEST JERSEY AVENUE



See Adjoining Sheet 14

\* EXEMPT TOWNSHIP OF HAMILTON  
NOTE: LETTERS "LL1" INDICATES NUMBER ON MAP OF INDUSTRIAL LAND COMPANY.

See Adjoining Sheet 16

NEW JERSEY DEPARTMENT OF THE TREASURY  
DIVISION OF TAXATION  
LOCAL PROPERTY AND PUBLIC UTILITY BRANCH  
APPROVED AS A TAX MAP PURSUANT TO THE  
PROVISIONS OF CHAPTER 175, LAWS OF 1913, ETC.  
FOR THE DIRECTOR, DIVISION OF TAXATION

*Alexander N. Churchill*  
P.E.S.L.  
LIC. #15434 CHIEF, ENGINEERING SECTION  
DATE JAN 22 1988 SERIAL NO. 854

NEW JERSEY DEPARTMENT OF THE TREASURY  
DIVISION OF TAXATION  
LOCAL PROPERTY AND PUBLIC UTILITY BRANCH  
APPROVED AS A TAX MAP PURSUANT TO THE  
PROVISIONS OF CHAPTER 175, LAWS OF 1913, ETC.  
FOR THE DIRECTOR, DIVISION OF TAXATION

*Ronald J. Price*  
P.E. & L.S.  
LIC. # 5009  
DATE JAN 22 1988 SERIAL NO. 854

TAX MAP  
TOWNSHIP OF HAMILTON  
ATLANTIC COUNTY, NEW JERSEY  
SCALE: 1" = 100' DATE: JUNE 1, 1977

RONALD J. PRICE  
PLEASANTVILLE, N.J.  
N.J. LICENSE #010901

REV. BY ALEXANDER N. CHURCHILL ASSOC.-JAN.'95, SEPT. 2007

REV. BY REMINGTON & VERNICK ENGINEERS - 1-8-2013  
REVISED BY CHURCHILL - JULY 2006, FEB. 2008