

ATLANTIC COUNTY

BUENA VISTA TOWNSHIP

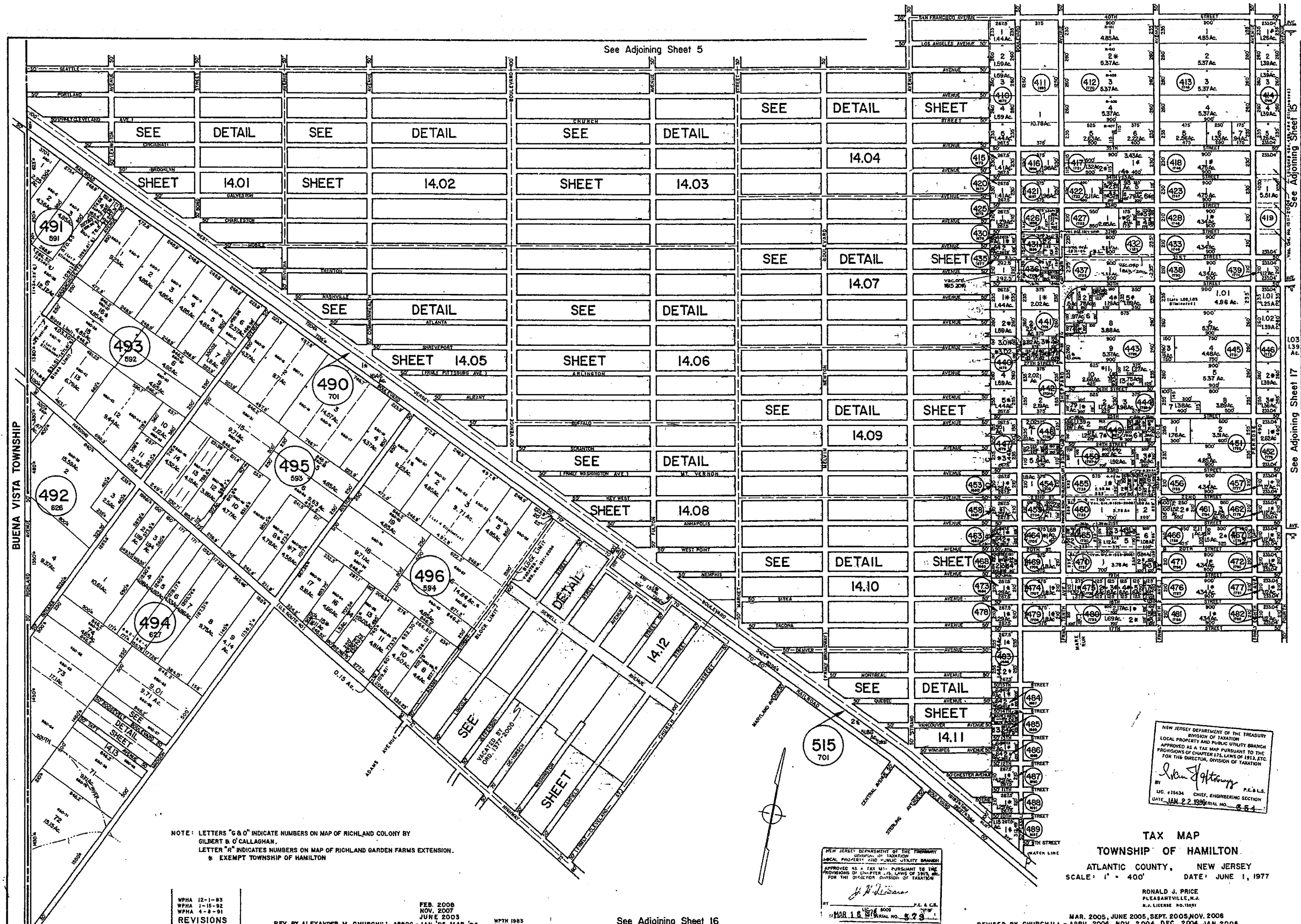

NOTE: LETTERS "G & O" INDICATE NUMBERS ON MAP OF RICHLAND COLONY BY GILBERT & O'CALLAGHAN.  
 LETTER "R" INDICATES NUMBERS ON MAP OF RICHLAND GARDEN FARMS EXTENSION.  
 \* EXEMPT TOWNSHIP OF HAMILTON

WPMA 12-1-83	FEB. 2008	REVISED BY RAY ENGINEERS - 8-10-2015 - CHARLES E. ADAMSON, L.S. 42827
WPMA 1-15-82	NOV. 2007	GEOSURV NJ - 5-4-2016 - HAROLD E. NOON, L.S. 34014
WPMA 4-8-91	JUNE 2003	GEOSURV NJ - 5-16-2016 - HAROLD E. NOON, L.S. 34014
REVISIONS		
3-2017	REV. BY ALEXANDER M. CHURCHILL ASSOC. - JAN. '95, MAR. '95	THOMAS A. PRENDERGAST L.S. 37604
8-13-18		ENGINEERING DESIGN ASSOC. L.S. 37994

FEB. 2008  
 NOV. 2007  
 JUNE 2003  
 WPMA 12-1-83  
 WPMA 1-15-82  
 WPMA 4-8-91  
 REVISIONS

See Adjoining Sheet 16

NEW JERSEY DEPARTMENT OF THE TREASURY  
 LOCAL PROPERTY AND PUBLIC UTILITY BRANCH  
 APPROVED AS A TAX MAP PURSUANT TO THE  
 PROVISIONS OF CHAPTER 175, LAWS OF 1982,  
 FOR THE DIRECTOR, DIVISION OF TAXATION  
 J. P. Williams  
 P.E. & C.E.  
 MAR 16 2008  
 SERIAL NO. 573

NEW JERSEY DEPARTMENT OF THE TREASURY  
 DIVISION OF TAXATION  
 LOCAL PROPERTY AND PUBLIC UTILITY BRANCH  
 APPROVED AS A TAX MAP PURSUANT TO THE  
 PROVISIONS OF CHAPTER 175, LAWS OF 1982,  
 FOR THE DIRECTOR, DIVISION OF TAXATION  
 John J. Higgins  
 P.E. & L.S.  
 LIC. #35434 CHIEF, ENGINEERING SECTION  
 DATE: JAN 22 1996 SERIAL NO. 454

TAX MAP  
 TOWNSHIP OF HAMILTON  
 ATLANTIC COUNTY, NEW JERSEY  
 SCALE: 1" = 400' DATE: JUNE 1, 1977

RONALD J. PRICE  
 PLEASANTVILLE, N.J.  
 N.J. LICENSE NO. 10-1501  
 MAR. 2005, JUNE 2005, SEPT. 2005, NOV. 2005  
 REVISED BY CHURCHILL - APRIL 2004, NOV. 2004, DEC. 2004, JAN. 2005