

REVISIONS		
DATE	NAME	NO.
10-11-77	FRANKLIN B. BROWN AND C. THOMAS A. FREEMAN	L.S. 37701

See Adjoining Sheet 31.01

See Adjoining Sheet 31.04

See Adjoining Sheet 31.05

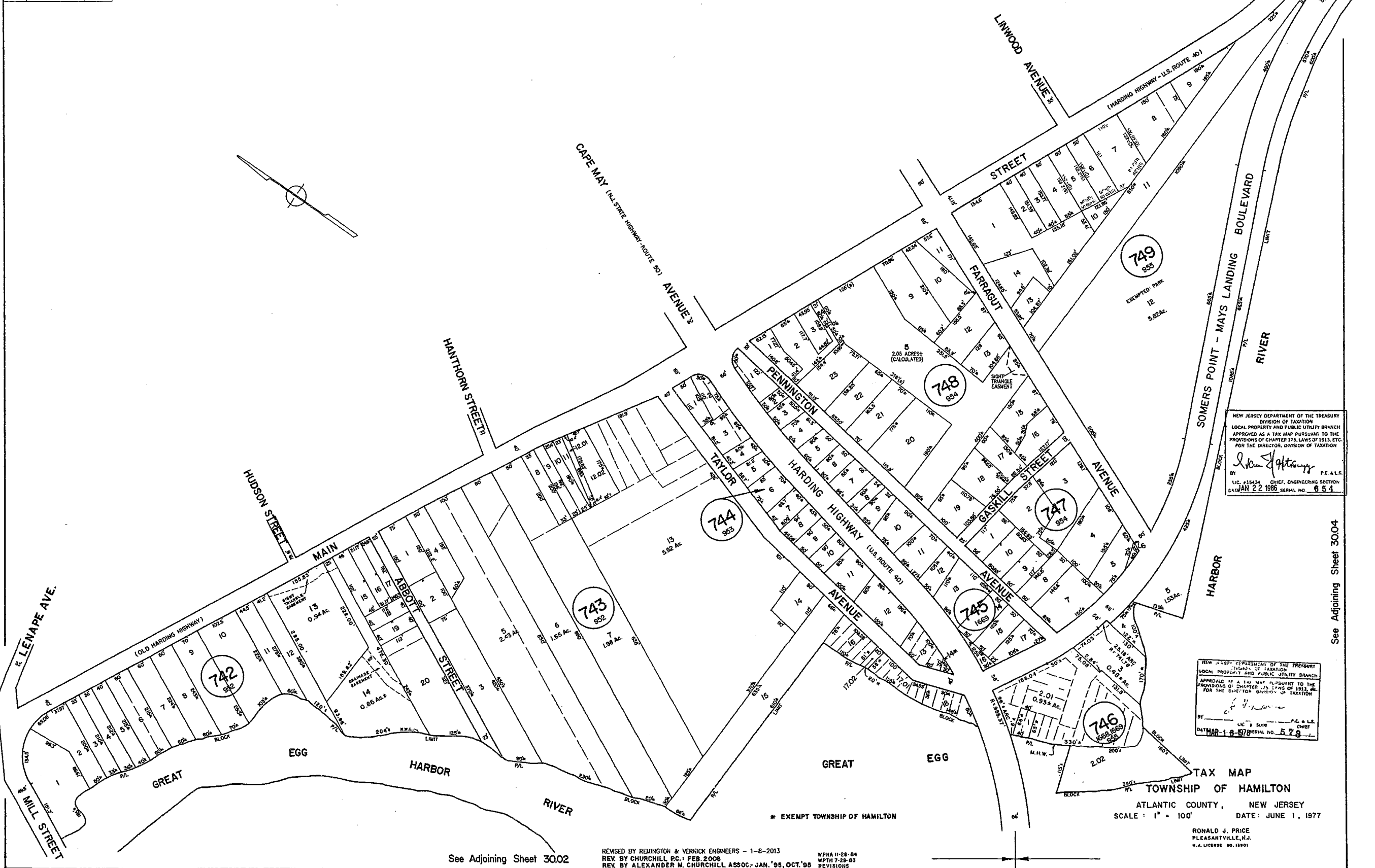

NEW JERSEY DEPARTMENT OF THE TREASURY
 DIVISION OF TAXATION
 LOCAL PROPERTY AND PUBLIC UTILITY BRANCH
 APPROVED AS A TAX MAP PURSUANT TO THE
 PROVISIONS OF CHAPTER 115, LAWS OF 1913, ETC.
 FOR THE DIRECTOR, DIVISION OF TAXATION

John J. Anthony P.E. & L.L.C.
 LIC. #15434 CHIEF, ENGINEERING SECTION
 DATE JAN 22 1986 SERIAL NO. 6.5.4

NEW JERSEY DEPARTMENT OF THE TREASURY
 DIVISION OF TAXATION
 LOCAL PROPERTY AND PUBLIC UTILITY BRANCH
 APPROVED AS A TAX MAP PURSUANT TO THE
 PROVISIONS OF CHAPTER 115, LAWS OF 1913, ETC.
 FOR THE DIRECTOR, DIVISION OF TAXATION

[Signature] P.E. & L.L.C.
 LIC. # 5478 CHIEF
 DATE MAR 14 1977 SERIAL NO. 5.7.8

TAX MAP
 TOWNSHIP OF HAMILTON
 ATLANTIC COUNTY, NEW JERSEY
 SCALE: 1" = 100'
 DATE: JUNE 1, 1977

RONALD J. PRICE
 PLEASANTVILLE, N.J.
 N.J. LICENSE NO. 13901

REVISED BY REMINGTON & VERNICK ENGINEERS - 1-8-2013
 REV. BY CHURCHILL P.C. FEB. 2008
 REV. BY ALEXANDER M. CHURCHILL ASSOC. JAN. '95, OCT. '95

WPHA II-28-84
 WPTH 7-29-83
 REVISIONS

See Adjoining Sheet 30.02

See Adjoining Sheet 30.04