

REVISIONS		
DATE	L.S. NAME	LIC. No.
2-4-58	MARTIN E. TARELLA	27477
1-5-13	ORAN F. RENNERTON	23924
5/21/18	ENGINEERING ASSOC. - PLEASANTVILLE, N.J.	L.S. 37604

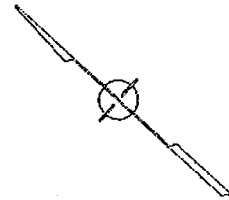

ATLANTIC COUNTY
GALLOWAY TOWNSHIP

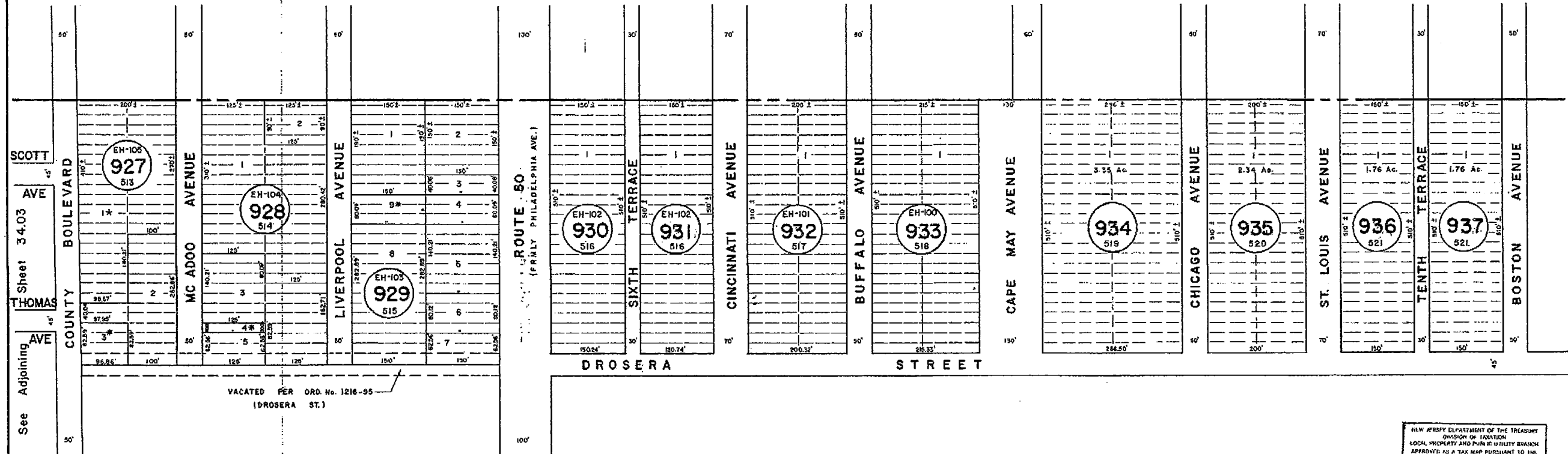

Sheet 34.03
See Adjoining Sheet 35.01

VACATED PER ORD. No. 1216-95
(DROSERA ST.)

NEW JERSEY DEPARTMENT OF THE TREASURY
DIVISION OF TAXATION
LOCAL PROPERTY AND PUBLIC UTILITY BRANCH
APPROVED AS A TAX MAP PURSUANT TO THE
PROVISIONS OF CHAPTER 125, LAWS OF 1913, ETC.
FOR THE TOWNSHIP OF GALLOWAY
By: *Alexander M. Churchill* P.E. & L.S.
LIC. 415424 CHIEF, ENGINEERING SECTION
DATE: 22 1986 SERIAL NO. 554

NEW JERSEY DEPARTMENT OF THE TREASURY
DIVISION OF TAXATION
LOCAL PROPERTY AND PUBLIC UTILITY BRANCH
APPROVED AS A TAX MAP PURSUANT TO THE
PROVISIONS OF CHAPTER 125, LAWS OF 1913, ETC.
FOR THE TOWNSHIP OF GALLOWAY
By: *Ronald J. Price* P.E. & L.S.
LIC. 25007 CHIEF
DATE: 10 1986 SERIAL NO. 578

TAX MAP
TOWNSHIP OF HAMILTON
ATLANTIC COUNTY, NEW JERSEY
SCALE: 1" = 100' DATE: JUNE 1, 1977

RONALD J. PRICE
PLEASANTVILLE, N.J.
N.J. LICENSE 25, 1981

* EXEMPT TOWNSHIP OF HAMILTON
LETTER 'E.H.' INDICATES NUMBER ON MAP OF E06 HARBOR CITY MANOR

See Adjoining Sheet 34

REV. BY CHURCHILL - FEB. 2006
REV. BY ALEXANDER M. CHURCHILL ASSOC. - JAN '85