

REVISIONS

WPMA 5-18-80
WPMA 11-7-91
WPMA 12-5-98

REVISIONS

DATE	L.S. NAME	L.I.C. NUMBER
10-23-97	KENNETH P. FRANK	LS 34787
12-31-97	MARTIN E. TIRELLA	LS 27477
1-20-98	MARTIN E. TIRELLA	LS 27477
2-4-98	MARTIN E. TIRELLA	LS 27477

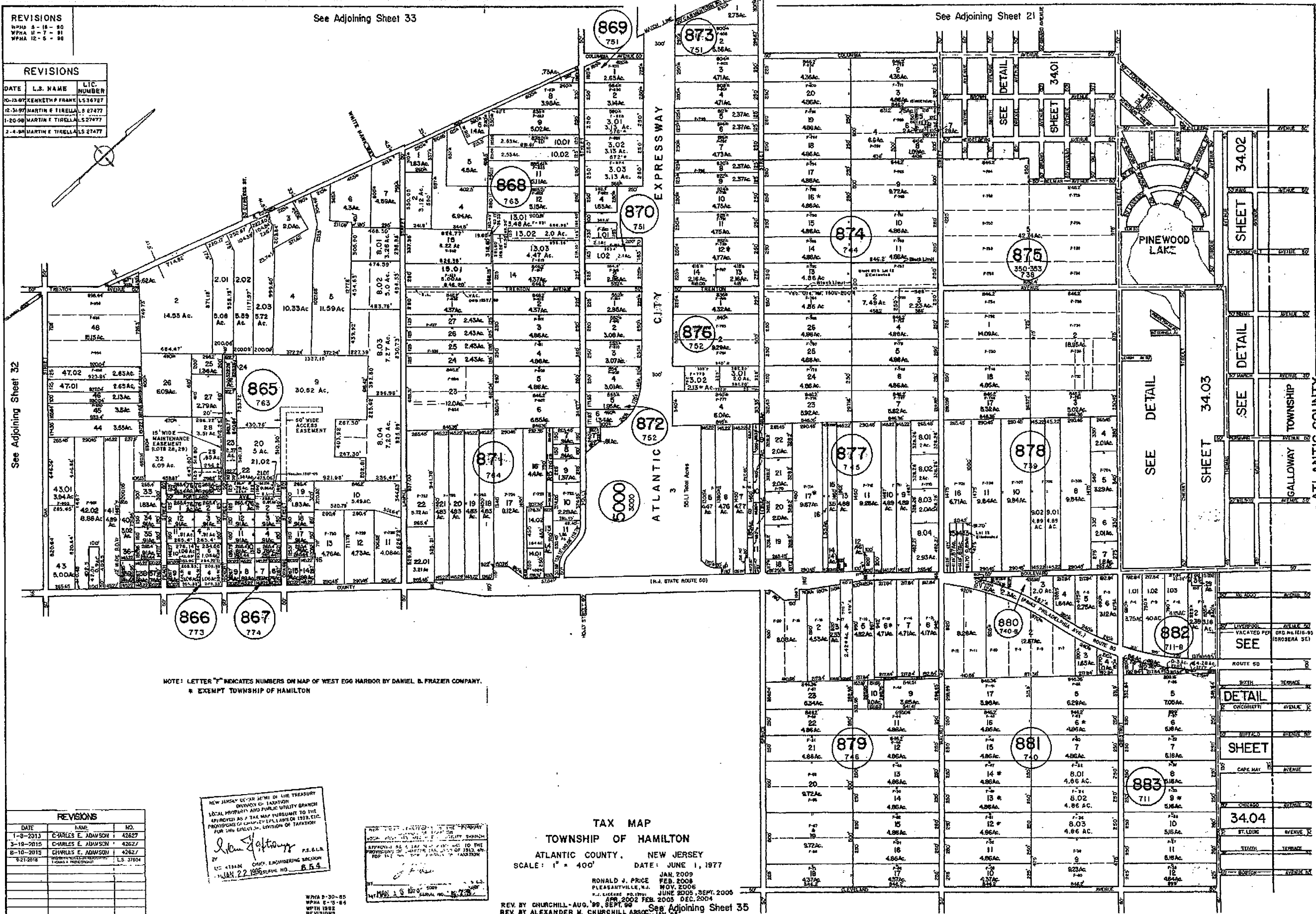

NOTE: LETTER "T" INDICATES NUMBERS ON MAP OF WEST EGG HARBOR BY DANIEL B. FRAZER COMPANY.
 * EXEMPT TOWNSHIP OF HAMILTON

REVISIONS

DATE	NAME	NO.
1-8-2013	CHARLES E. ADWSON	42627
3-19-2015	CHARLES E. ADWSON	42627
8-10-2015	CHARLES E. ADWSON	42627
9-21-2016	CHARLES E. ADWSON	LS 37604

NEW JERSEY DEPARTMENT OF THE TREASURY
 DIVISION OF TAXATION
 LOCAL PROPERTY AND PUBLIC UTILITY TAXES
 APPROVED AS A TAX MAP PURSUANT TO THE
 PROVISIONS OF CHAPTER 124, LAWS OF 1913, ETC.
 FOR THE PURPOSES OF DIVISION OF TAXATION

John J. Goffney
 P.E., S.E.
 4124 N. CHASE
 CHASE ENGINEERING ASSOCIATES
 JAN 22 2009
 B.54

NEW JERSEY DEPARTMENT OF THE TREASURY
 DIVISION OF TAXATION
 LOCAL PROPERTY AND PUBLIC UTILITY TAXES
 APPROVED AS A TAX MAP PURSUANT TO THE
 PROVISIONS OF CHAPTER 124, LAWS OF 1913, ETC.
 FOR THE PURPOSES OF DIVISION OF TAXATION

John J. Goffney
 P.E., S.E.
 4124 N. CHASE
 CHASE ENGINEERING ASSOCIATES
 JAN 22 2009
 B.54

TAX MAP
 TOWNSHIP OF HAMILTON
 ATLANTIC COUNTY, NEW JERSEY
 SCALE: 1" = 400'
 DATE: JUNE 1, 1977

RONALD J. PRICE
 PLEASANTVILLE, N.J.
 JUNE 2006
 APR. 2002 FEB. 2005 SEPT. 2005
 REV. BY CHURCHILL-AUG. 99, SEPT. 99
 REV. BY ALEXANDER M. CHURCHILL ASSOC. JAN. 05