

REVISIONS

WPNA 11-18-87
WPNA 2-17-89

REVISIONS

DATE	L.S. NAME	L.I.C. NO.
12-31-87	MARTIN F. TIRRELLA	27477
11-18-88	MARTIN F. TIRRELLA	27477
7-20-11	GRAVE F. REMINGTON	23924
3-3-16	HAROLD MOON	34014
8/21/18	ENGINEERING DESIGN ALLIANCE THOMAS & PRINCE INC.	L.S. 37694

See Adjoining Sheet 35

See Adjoining Sheet 41

See Adjoining Sheet 32

See Adjoining Sheet 47

See Adjoining Sheet 46

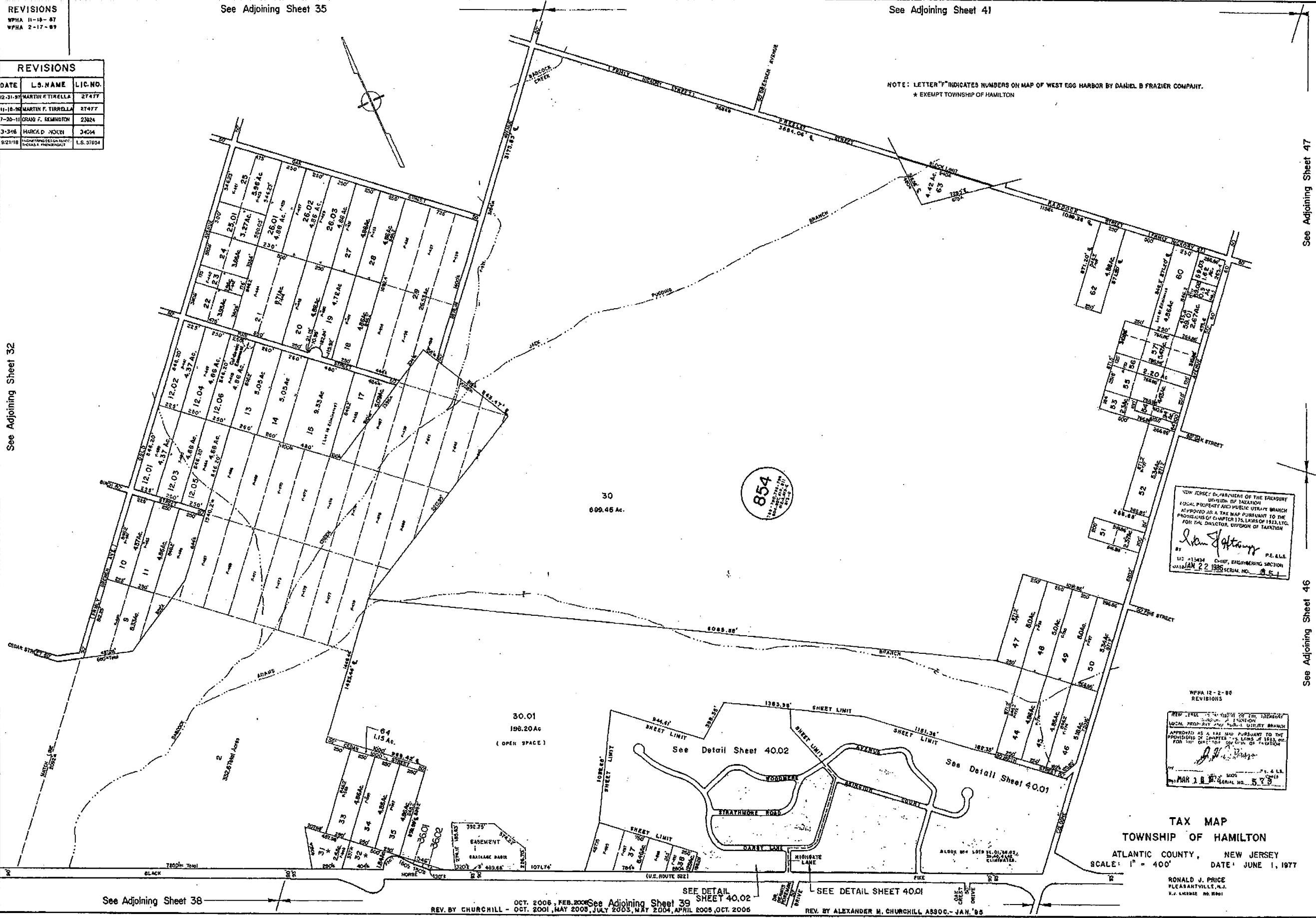

NEW JERSEY DEPARTMENT OF THE TREASURY  
DIVISION OF TAXATION  
LOCAL PROPERTY AND PUBLIC UTILITY BRANCH  
APPROVED AS A TAX MAP PURSUANT TO THE  
PROVISIONS OF CHAPTER 133, L.R.S. OF 1953, ET  
SEQ. FOR THE DIRECTOR, DIVISION OF TAXATION

*Alexander M. Churchill*  
LIC #13834 CHIEF, ENGINEERING SECTION  
JAN 22 1995 SERIAL NO. 854

WPNA 12-2-88  
REVISIONS

NEW JERSEY DEPARTMENT OF THE TREASURY  
DIVISION OF TAXATION  
LOCAL PROPERTY AND PUBLIC UTILITY BRANCH  
APPROVED AS A TAX MAP PURSUANT TO THE  
PROVISIONS OF CHAPTER 133, L.R.S. OF 1953, ET  
SEQ. FOR THE DIRECTOR, DIVISION OF TAXATION

*Alexander M. Churchill*  
LIC #13834 CHIEF, ENGINEERING SECTION  
MAR 18 1997 SERIAL NO. 854

TAX MAP  
TOWNSHIP OF HAMILTON  
ATLANTIC COUNTY, NEW JERSEY  
SCALE: 1" = 400' DATE: JUNE 1, 1977

RONALD J. PRICE  
PLEASANTVILLE, N.J.  
L.S. LICENSE NO. 8901

See Adjoining Sheet 38

SEE DETAIL SHEET 40.02  
SEE DETAIL SHEET 40.01  
SEE DETAIL SHEET 40.01  
SEE DETAIL SHEET 40.01

OCT. 2006, FEB. 2008, MAY 2009, JULY 2005, MAY 2004, APRIL 2005, OCT. 2006  
REV. BY CHURCHILL

SEE DETAIL SHEET 40.01  
SEE DETAIL SHEET 40.01  
SEE DETAIL SHEET 40.01  
SEE DETAIL SHEET 40.01

REV. BY ALEXANDER M. CHURCHILL ASSOC. - JAN. '85