

See Adjoining Sheet 49

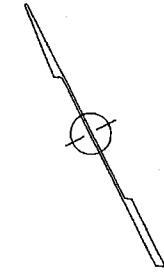
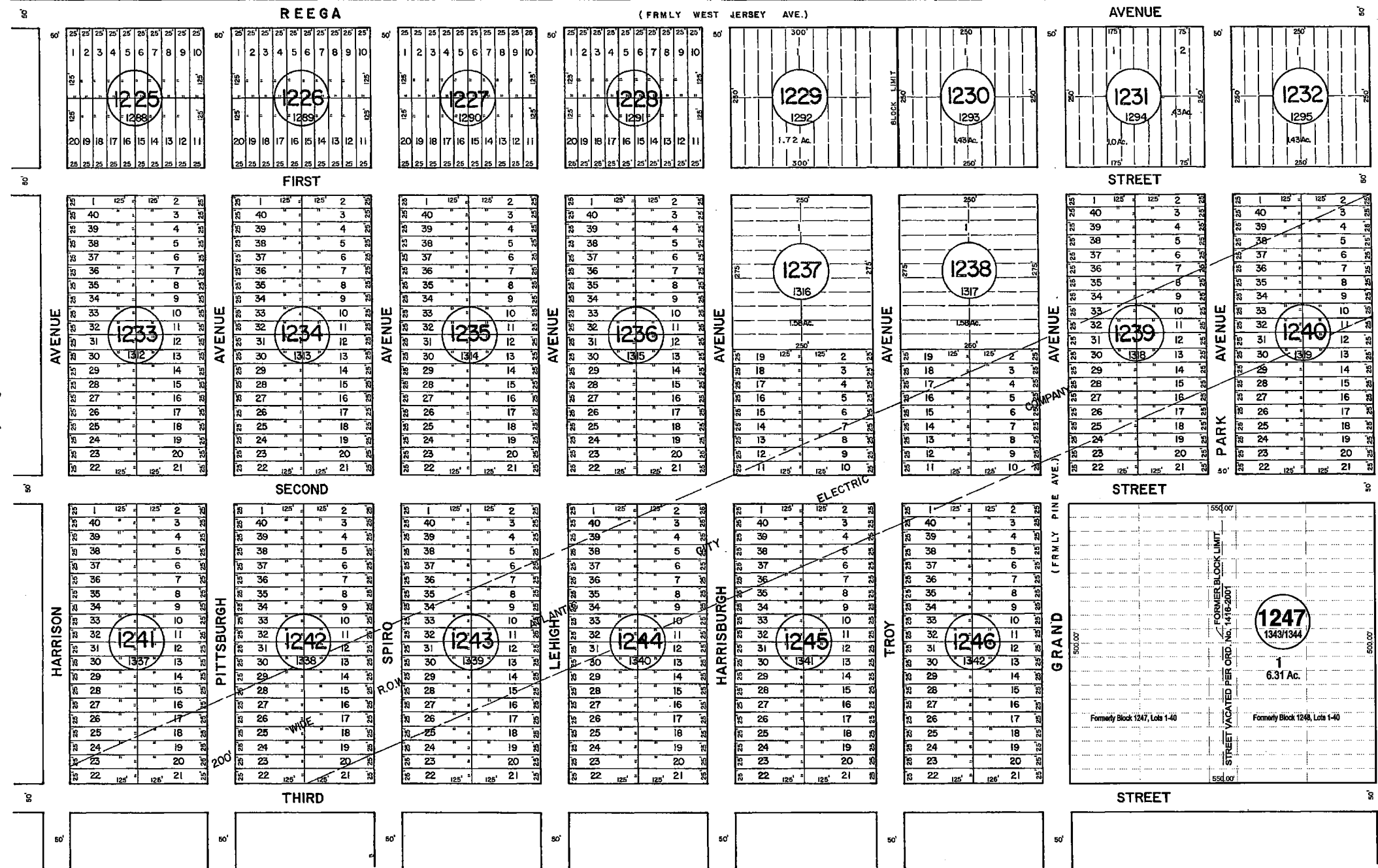

See Adjoining Sheet 48.02

See Adjoining Sheet 48

REVISIONS		
DATE	NAME	NO.
3-2017	DIXON ASSOCIATES/ THOMAS A. PRENDERGAST	L.S. 37604

REV. BY CHURCHILL - MAY 2002
 REV. BY ALEXANDER M. CHURCHILL ASSOC. - JAN. '95

See Adjoining Sheet 48.06

WPHA 6-25-86 REVISIONS

NEW JERSEY DEPARTMENT OF THE TREASURY
 DIVISION OF TAXATION
 LOCAL PROPERTY AND PUBLIC UTILITY BRANCH
 APPROVED AS A TAX MAP PURSUANT TO THE
 PROVISIONS OF CHAPTER 175, LAWS OF 1913, ETC.
 FOR THE DIRECTOR, DIVISION OF TAXATION
Alan J. Hartung
 BY: P.E. & L.S.
 LIC. #15434 CHIEF, ENGINEERING SECTION
 DATE: JAN 22 1986, SERIAL NO. 054

NEW JERSEY DEPARTMENT OF THE TREASURY
 DIVISION OF TAXATION
 LOCAL PROPERTY AND PUBLIC UTILITY BRANCH
 APPROVED AS A TAX MAP PURSUANT TO THE
 PROVISIONS OF CHAPTER 175, LAWS OF 1913, ETC.
 FOR THE DIRECTOR, DIVISION OF TAXATION
Ronald J. Price
 BY: P.E. & L.S.
 DATE: JAN 16 1977, SERIAL NO. 572
 CHIEF

TAX MAP
 TOWNSHIP OF HAMILTON
 ATLANTIC COUNTY, NEW JERSEY
 SCALE: 1" = 100' DATE: JUNE 1, 1977

RONALD J. PRICE
 PLEASANTVILLE, N.J.
 N.J. LICENSE NO. 15901