

REVISIONS		
DATE	SURVEYOR	LIC. No.

NOTES:
 1. THIS SHEET HAS BEEN DRAWN USING A COMPUTER AIDED DRAFTING AND DESIGN.
 2. CONDOMINIUM DATA/GRAPHICS SHOWN PER INFORMATION OBTAINED FROM - "FIRST AMENDED AND RESTATED MASTER DEED FOR VICTORIA CROSSING CONDOMINIUM, TOWNSHIP OF HAMILTON, ATLANTIC COUNTY, NEW JERSEY" AS FILED IN THE ATLANTIC COUNTY CLERK'S OFFICE AS CFN#0243866, BOOK 7099, PAGES 1 THRU 98, RECORDED DATE 12/05/2001.

SEE SHEET 49
 BLOCK LIMIT

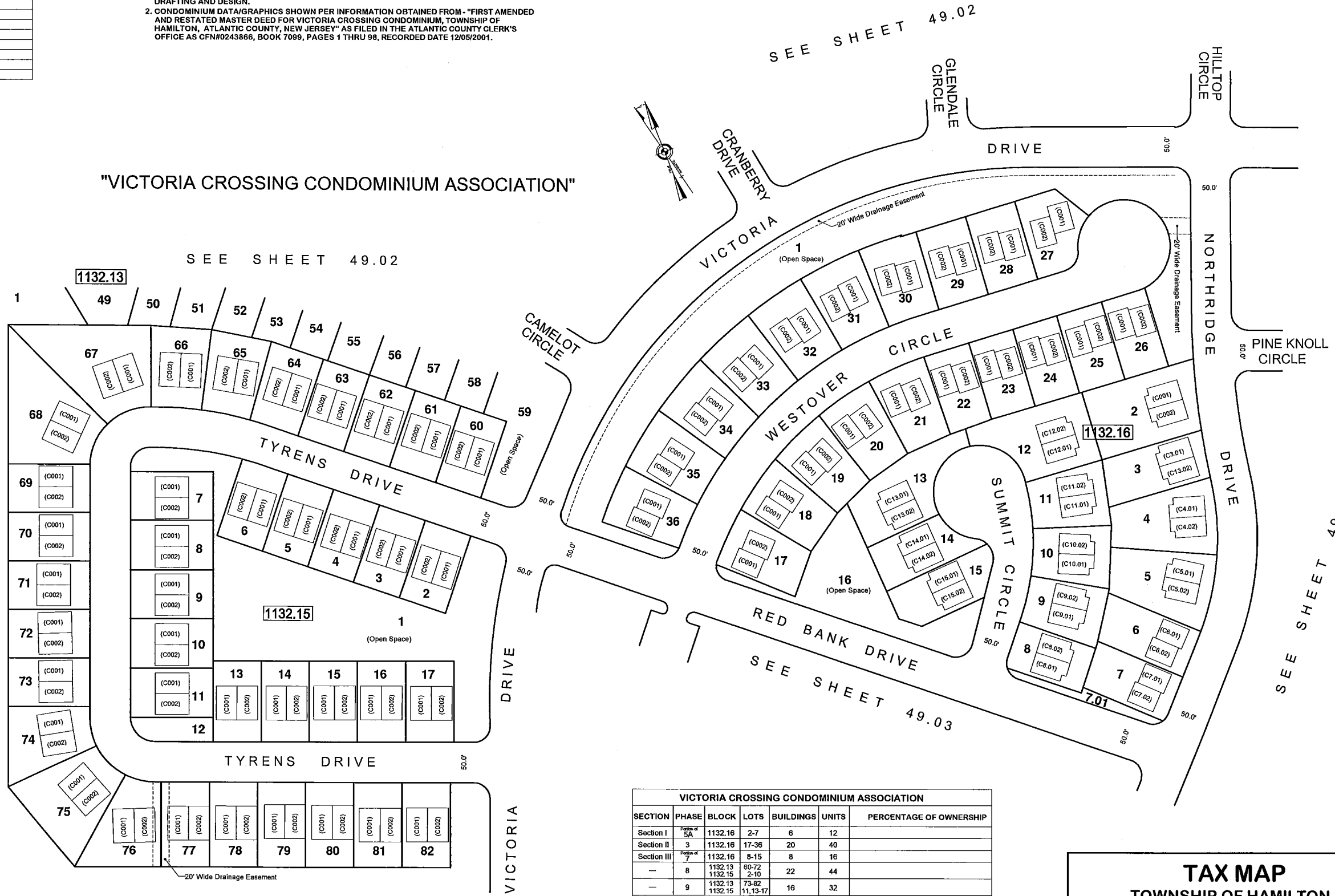

SEE SHEET 49.02

PLAN

SCALE: 1" = 60'

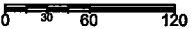

VICTORIA CROSSING CONDOMINIUM ASSOCIATION						
SECTION	PHASE	BLOCK	LOTS	BUILDINGS	UNITS	PERCENTAGE OF OWNERSHIP
Section I	Part of SA	1132.16	2-7	6	12	
Section II		1132.16	17-36	20	40	
Section III	Part of 7	1132.16	8-15	8	16	
—	8	1132.13	60-72	22	44	
—	9	1132.15	2-10	16	32	
FULL BUILD-OUT				72	144	0.69444% (1/144 = 0.0069444)

NOTE:
 Chart represents attachment to Master Deed (See Note 2 Above) Fee Percentage Schedule Victoria Crossing Condominium Association"

TAX MAP
 TOWNSHIP OF HAMILTON
 ATLANTIC COUNTY NEW JERSEY
 SCALE: AS SHOWN DATE: APRIL 12, 2017

DIXON ASSOCIATES
 335 E. JIMMIE LEEDS ROAD,
 GALLOWAY TOWNSHIP, N.J. 08205
 THOMAS A. PRENDERGAST, P.L.S.
 N.J. LIC. No. 37604