

REVISIONS

WPHA 2-21-88
WPHA 11-12-80
WPHA 10-18-81
WPHA 3-12-83
WPHA 4-12-86
WPHA 12-17-96

REVISIONS

DATE	LS NAME	LIC. NO.
9-29-98	MARTIN TIRELLA	27477
1/29/99	MARTIN TIRELLA	27477
3-2017	OXON ASSOCIATES/ THOMAS A. PRINCENOMIT	L.S. 37604
5-2017	OXON ASSOCIATES/ THOMAS A. PRINCENOMIT	L.S. 37604
6-2017	OXON ASSOCIATES/ THOMAS A. PRINCENOMIT	L.S. 37604
11-2017	OXON ASSOCIATES/ THOMAS A. PRINCENOMIT	L.S. 37604

See Adjoining Sheet 45

See Adjoining Sheet 46

NEW JERSEY DEPARTMENT OF THE TREASURY
DIVISION OF TAXATION
LOCAL PROPERTY AND PUBLIC UTILITY BRANCH
APPROVED AS A TAX MAP PURSUANT TO THE
PROVISIONS OF CHAPTER 173, LAWS OF 1977, 1986
FOR THE DIRECTOR, DIVISION OF TAXATION

J. H. Wilson P.E. & L.S.
MAR 10 1978 8000
SERIAL NO. 873

TAX MAP
TOWNSHIP OF HAMILTON
ATLANTIC COUNTY, NEW JERSEY
SCALE: 1" = 400'
DATE: JUNE 1, 1977

RONALD J. PRICE
PLEASANTVILLE, N.J.
N.J. LICENSE NO. 13901

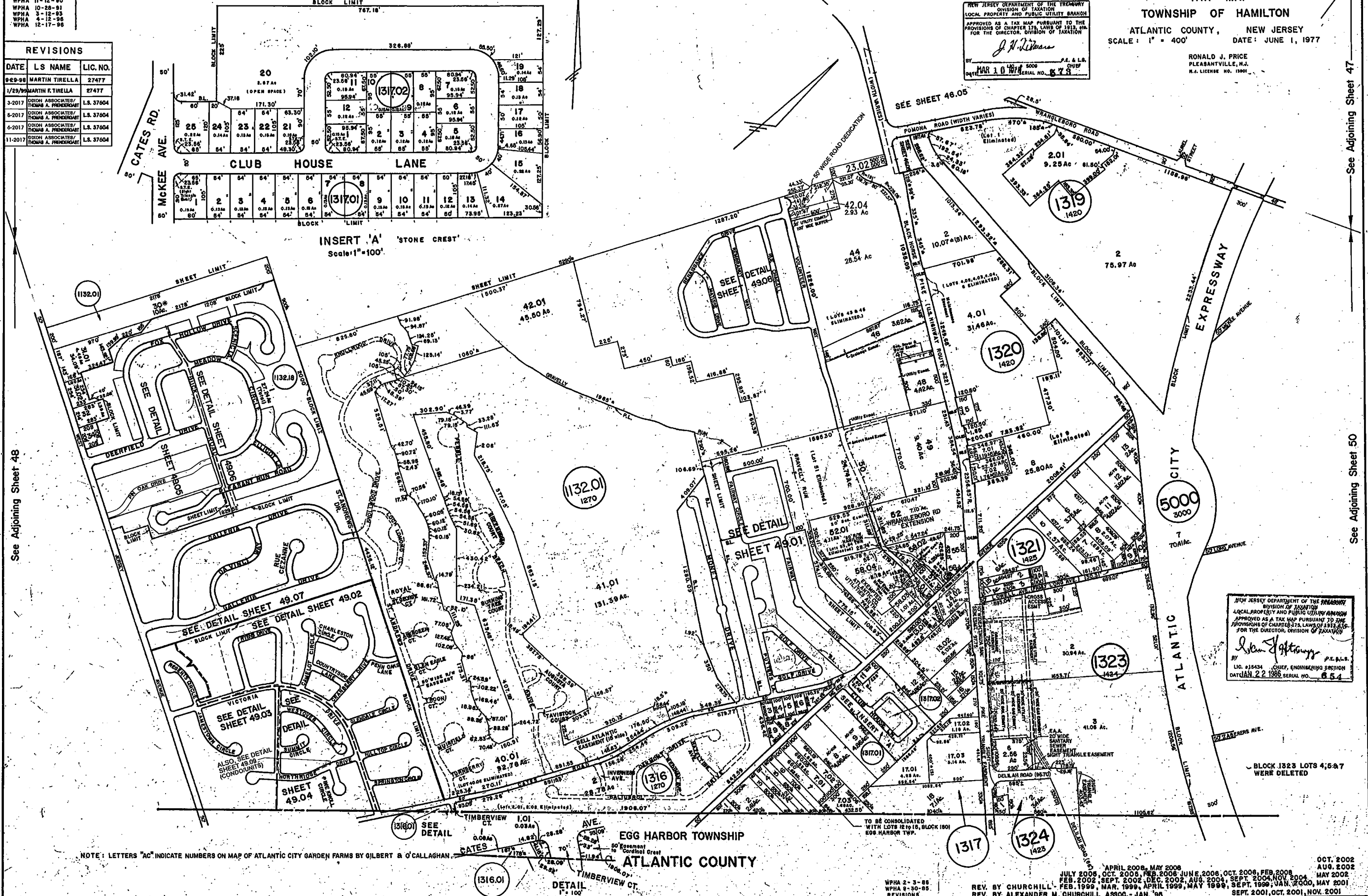

See Adjoining Sheet 48

See Adjoining Sheet 47

See Adjoining Sheet 50

NOTE: LETTERS "ac" INDICATE NUMBERS ON MAP OF ATLANTIC CITY GARDEN FARMS BY GILBERT & O'CALLAGHAN.

EGG HARBOR TOWNSHIP
ATLANTIC COUNTY

NEW JERSEY DEPARTMENT OF THE TREASURY
DIVISION OF TAXATION
LOCAL PROPERTY AND PUBLIC UTILITY BRANCH
APPROVED AS A TAX MAP PURSUANT TO THE
PROVISIONS OF CHAPTER 173, LAWS OF 1977, 1986
FOR THE DIRECTOR, DIVISION OF TAXATION

Richard J. Hoffmeyer P.E. & L.S.
LIC. #18434 CHIEF ENGINEERING SECTION
DATE JAN 22 1986 SERIAL NO. 854

BLOCK 1323 LOTS 4,5,6,7 WERE DELETED

APRIL 2008, MAY 2008
JULY 2005, OCT. 2006, FEB. 2006, JUNE 2006, OCT. 2006, FEB. 2008
AUG. 2002
REV. BY CHURCHILL - FEB. 1999, MAR. 1999, APRIL 1999, MAY 1999, SEPT. 1999, JAN. 2000, MAY 2001
REV. BY ALEXANDER M. CHURCHILL, ASSOC. - JAN. '98
OCT. 2002
AUG. 2002
MAY 2002
SEPT. 2001, OCT. 2001, NOV. 2001