

REVISIONS		
DATE	NAME	NO.
12-20-85	JOHN R. WALKER	10294
6-16-86	JOHN R. WALKER	10294
12-24-86	JOHN R. WALKER	10294
6-8-87	JOHN R. WALKER	10294
12-3-87	JOHN R. WALKER	10294
6-15-88	JOHN R. WALKER	10294
12-21-88	JOHN R. WALKER	10294
6-8-89	JOHN R. WALKER	10294
12-29-89	JOHN R. WALKER	10294
5-22-90	JOHN R. WALKER	10294
11-12-90	JOHN R. WALKER	10294
5-10-91	JOHN R. WALKER	10294
11-12-91	JOHN R. WALKER	10294
7-1-92	JOHN R. WALKER	10294
12-30-92	JOHN R. WALKER	10294
4-30-96	JOHN R. WALKER	10294

JUNE 1985
DECEMBER 1984
JUNE 1984
DECEMBER 1983
JUNE 1983
DECEMBER 1982
DECEMBER 1981
DECEMBER 1980
DECEMBER 1979
DECEMBER 1978
APRIL 1978
REVISIONS

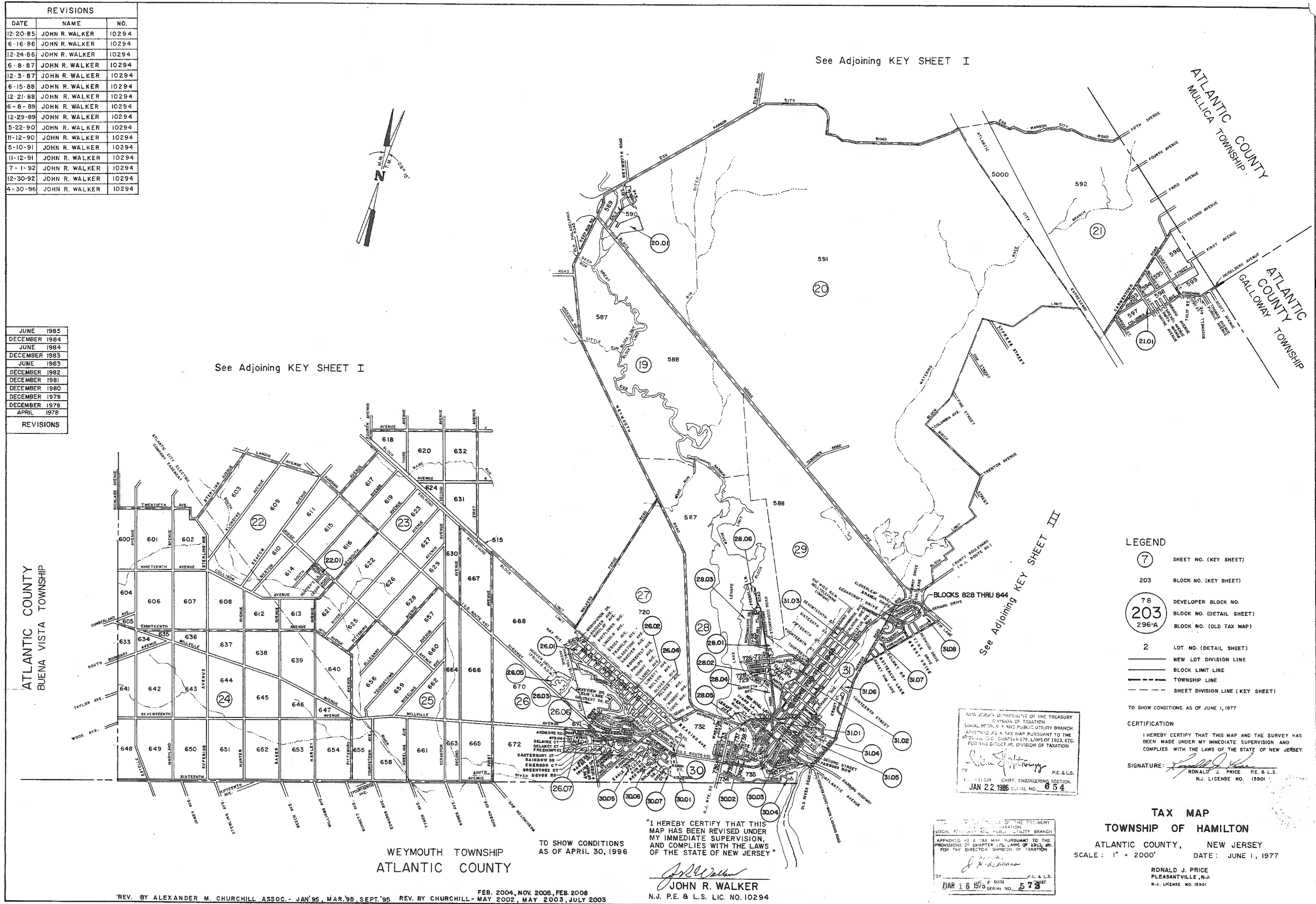

ATLANTIC COUNTY
BUENA VISTA TOWNSHIP

WEYMOUTH TOWNSHIP
ATLANTIC COUNTY

REV. BY ALEXANDER M. CHURCHILL ASSOC. - JAN '95, MAR '95, SEPT '95 REV. BY CHURCHILL - MAY 2002, MAY 2003, JULY 2003
FEB. 2004, NOV. 2005, FEB. 2008

"I HEREBY CERTIFY THAT THIS MAP HAS BEEN REVISED UNDER MY IMMEDIATE SUPERVISION, AND COMPLIES WITH THE LAWS OF THE STATE OF NEW JERSEY"

John R. Walker
JOHN R. WALKER
N.J. P.E. & L.S. LIC. NO. 10294

AND COUNTY COMMISSIONERS OF THE TREASURY DIVISION OF TAXATION LOCAL PUBLIC AND PUBLIC UTILITY BRANCH APPROVED AS A TAX MAP PURSUANT TO THE PROVISIONS OF CHAPTER 176, LAWS OF 1952, ETC. FOR THE DIRECTOR, DIVISION OF TAXATION

Ronald J. Price
RONALD J. PRICE P.E. & L.S.
N.J. LICENSE NO. 13901

JAN 22 1985 CHIEF ENGINEERING SECTION SERIAL NO. 654

AND COUNTY COMMISSIONERS OF THE TREASURY DIVISION OF TAXATION LOCAL PUBLIC AND PUBLIC UTILITY BRANCH APPROVED AS A TAX MAP PURSUANT TO THE PROVISIONS OF CHAPTER 176, LAWS OF 1952, ETC. FOR THE DIRECTOR, DIVISION OF TAXATION

Ronald J. Price
RONALD J. PRICE P.E. & L.S.
N.J. LICENSE NO. 13901

JAN 16 1970 CHIEF ENGINEERING SECTION SERIAL NO. 573

TAX MAP
TOWNSHIP OF HAMILTON
ATLANTIC COUNTY, NEW JERSEY
SCALE: 1" = 2000' DATE: JUNE 1, 1977

LEGEND

- ⑦ SHEET NO. (KEY SHEET)
- 203 BLOCK NO. (KEY SHEET)
- 78 DEVELOPER BLOCK NO.
- 203 BLOCK NO. (DETAIL SHEET)
- 296-A BLOCK NO. (OLD TAX MAP)
- 2 LOT NO. (DETAIL SHEET)
- NEW LOT DIVISION LINE
- BLOCK LIMIT LINE
- TOWNSHIP LINE
- SHEET DIVISION LINE (KEY SHEET)

TO SHOW CONDITIONS AS OF JUNE 1, 1977

CERTIFICATION

I HEREBY CERTIFY THAT THIS MAP AND THE SURVEY HAS BEEN MADE UNDER MY IMMEDIATE SUPERVISION AND COMPLIES WITH THE LAWS OF THE STATE OF NEW JERSEY.

SIGNATURE: *Ronald J. Price*
RONALD J. PRICE P.E. & L.S.
N.J. LICENSE NO. 13901